

SEOUL

Danurim Guidebook
for Accessible Tourism

1 Seodaemun Independence Park



Public Transportation

Take the subway to Dongnimun Station (Line 3) and walk for a minute from the elevator at Exit No. 4.

Facilities

Toilet for the disabled Inside Visitor Center, next to the parking lot
Nursing room Inside Visitor Center
Wheelchair rental Inside Visitor Center
Stroller rental Inside Visitor Center

Operating Hours

Always open

P Parking

Compact car KRW 1,800 for 1 hr
Additional fee KRW 150 every 5 mins after 1 hr
Midsize car KRW 5,400 for 1 hr
Additional fee KRW 450 every 5 mins after 1 hr
 * 80% off for the disabled drivers and men of national merit

2 Gyeonghuigung Palace

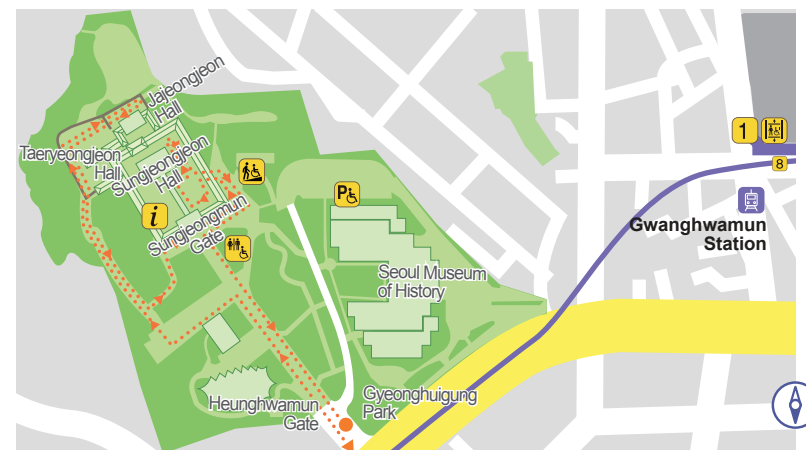

Public Transportation

Take the subway to Gwanghwamun Station (Line 5) and walk for 15 minutes from the elevator at Exit No. 1.

Facilities

Family toilet Seoul Museum of History
Nursing room Seoul Museum of History

Operating Hours

09:00~18:00

* Closed on Mondays, January 1st

P Parking

Open 8:00~22:00

Compact car KRW 1,000 for 1 hr

Additional fee

KRW 400 every 5 min after 1 hr

Full-sized car KRW 3,000 for 1 hr

Additional fee

KRW 800 every 5 min after 1 hr

* 80% off for the disabled drivers, men of national merit, and the patients who suffer from aftereffects of exposure to defoliants

* 30~50% off for compact cars, low-emission cars, and Dadoongee card holders, etc.

3 Seoul Museum of History



Public Transportation

Take the subway to Gwanghwamun Station (Line 5) and walk for 7 minutes from the elevator at Exit No. 1.

Facilities

Toilet for the disabled (Family toilet)
Next to Information Desk, The Historical Archives of Seoul

Diaper deck inside family toilets on 1F

Nursing room Next to Cafeteria 1F

Wheelchair rental Information Desk (1F)

Stroller rental Information Desk (1F)

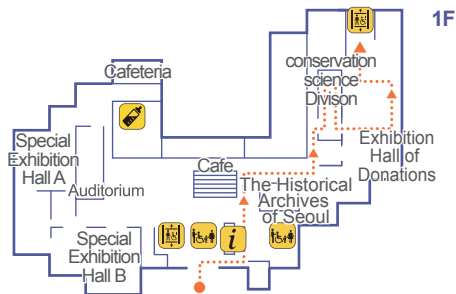

Operating Hours

March - October

Weekdays 9:00~20:00

Weekends & Holidays 9:00~19:00

November - February

Weekdays 9:00~20:00

Weekends & Holidays 9:00~18:00

* Closed on Mondays & January 1st

Parking

Open 8:00~22:00

Compact car KRW 1,000 for 1 hr

Additional fee

KRW 400 every mins after 1 hr

Full-sized car KRW 3,000 for 1 hr

Additional fee

KRW 800 every mins after 1 hr

* 80% off for the disabled drivers, men of national merit, and the patients who suffer from aftereffects of exposure to defoliants

* 30~50% off for compact cars, low-emission cars, and Dadoongee card holders, etc.

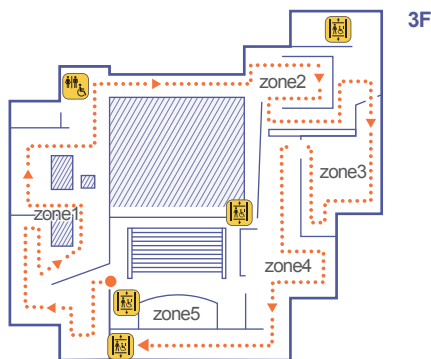

4 Cheongwadae Sarangchae



Public Transportation

Take the subway to Gyeongbokgung Station (Line 3) and walk for 15 minutes from the elevator at Exit No. 4.

Facilities

Toilet for the disabled

Next to Lounge (1F)

Family toilet

Inside toilet for the disabled

Diaper deck

Inside toilet for the disabled and nursing room

Nursing room Inside Lounge

Wheelchair rental Information Desk

Stroller rental Information Desk

Stroller parking Information Desk

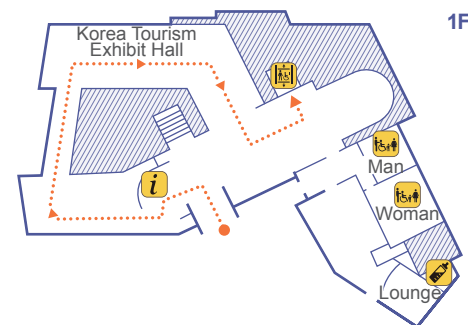

Operating Hours

9:00~18:00

* Closed on Mondays, January 1st, Lunar New Year's Day, and holidays

Parking

Use Gyeongbokgung Palace parking lot

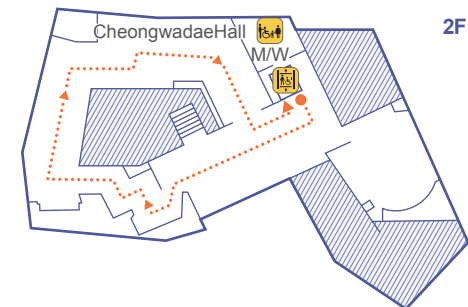

5 Gyeongbokgung Palace



Public Transportation

Take the subway to Gyeongbokgung Station (Line 3) and walk for 5 minutes from the elevator at Exit No. 4.

Facilities

Toilet for the disabled
National Folk Museum of Korea, Heungbokjeon, Hamhwadang, Jiggyeongdang, parking lot, and near Donggung Palace

Nursing room

Next to the toilet nearby parking lot

Wheelchair rental

Next to Heungnyemun Gate

Stroller rental

Next to Heungnyemun Gate

Operating Hours

January–February
9:00–17:00 (Last entrance at 16:00)

March–May
9:00–18:00 (Last entrance at 17:00)

June–August
9:00–18:30 (Last entrance at 17:30)

September–October
9:00–18:00 (Last entrance at 17:00)

November–December
9:00–17:00 (Last entrance at 16:00)

* Closed on Tuesdays

Parking

Compact car KRW 3,000 for 2 hrs

Additional fee

KRW 800 every 10 mins after 2 hrs

Mid/full-sized car KRW 5,000 for 2 hrs

Additional fee

KRW 800 every 10 mins after 2 hrs

* 80% off for the disabled drivers and men of national merit

* 50% off for compact cars, electric cars,

Dadoongee card (family card with more than three children) holders

6 The National Folk Museum of Korea



Public Transportation

Take the subway to Gyeongbokgung Station (Line 3) and walk for 13 minutes from the elevator at Exit No. 4.

Facilities

Toilet for the disabled

Next to the Lounge and Children's Museum

Family toilet Toilet inside Children's Museum

Diaper deck

Toilet for the disabled and nursing room

Nursing room Children's Museum

Wheelchair rental Information Desk

Wheelchair rental Information Desk

Operating Hours

March - October

9:00–18:00 (Last entrance at 17:00)

November - February

9:00–17:00 (Last entrance at 16:00)

Weekends & Holidays 9:00–19:00

* Closed on January 1st, Lunar New Year's Day & Chuseok

Parking

Compact car KRW 3,000 for 2 hrs

Mid/full-sized car KRW 5,000 for 2 hrs

Additional fee

KRW 800 every 10 mins after 2 hrs

* 80% off for the disabled drivers and men of national merit

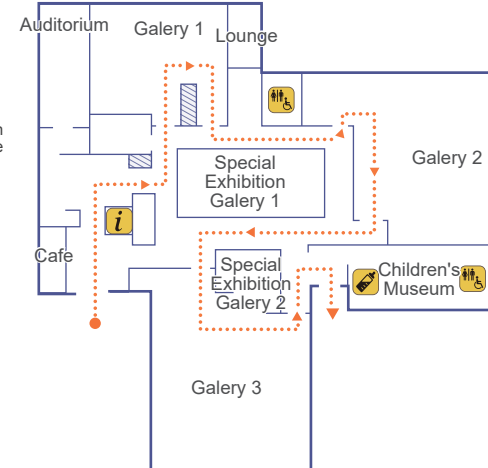

7 National Museum of Modern and Contemporary Art Seoul



Public Transportation

Take the subway to Anguk Station (Line 3) and walk for 11 minutes from the elevator at Exit No. 6.

Facilities

Toilet for the disabled Cafeteria, Art zone (1F),

Gallery 2, Gallery 7, Gallery Madang (B1)

Family toilet Gallery Madang

Diaper deck Art zone

Nursing room Art zone

Wheelchair rental Information Desk

Stroller rental Information Desk

Operating Hours

Mon/Tue/Wed/Thu/Sun 10:00–18:00

Fri & Sat 10:00–21:00

* Closed on January 1st, Lunar New Year's Day & Chuseok (Last entrance - 1 hour before)

Parking

8:00–23:00 KRW 3,000 per hr

Additional fee KRW 500 every 10 mins after 1 hr

* 50% off for the disabled drivers, compact cars, electric cars, Dadoongee card holders.

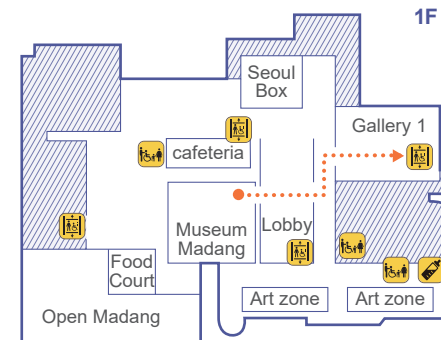
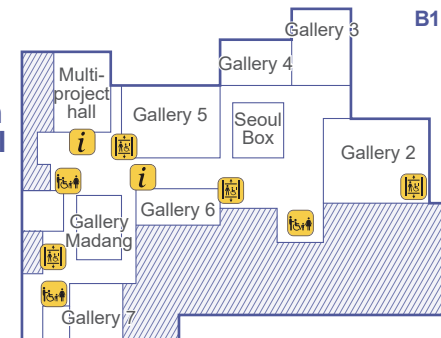

8 Changdeokkung Palace



Public Transportation

Take a low floor bus at Exit No. 6, Anguk Station (Line 3) (2 mins) and walk for 4 minutes from the bus stop. (Bus #151, 170, 171, 172, 109, 162, 272, 01A)



Facilities

Toilet for the disabled

Nakseonjae Area

Family toilet All toilets

Nursing room

Next to the toilet nearby Naksunjae

Wheelchair rental Visitor Center

Stroller rental Visitor Center



Operating Hours

February - May,

September - October 9:00~18:00

June - August 9:00~18:30

November - January 9:00~14:30

(Last entrance - 1 hour before)

* Closed on Mondays

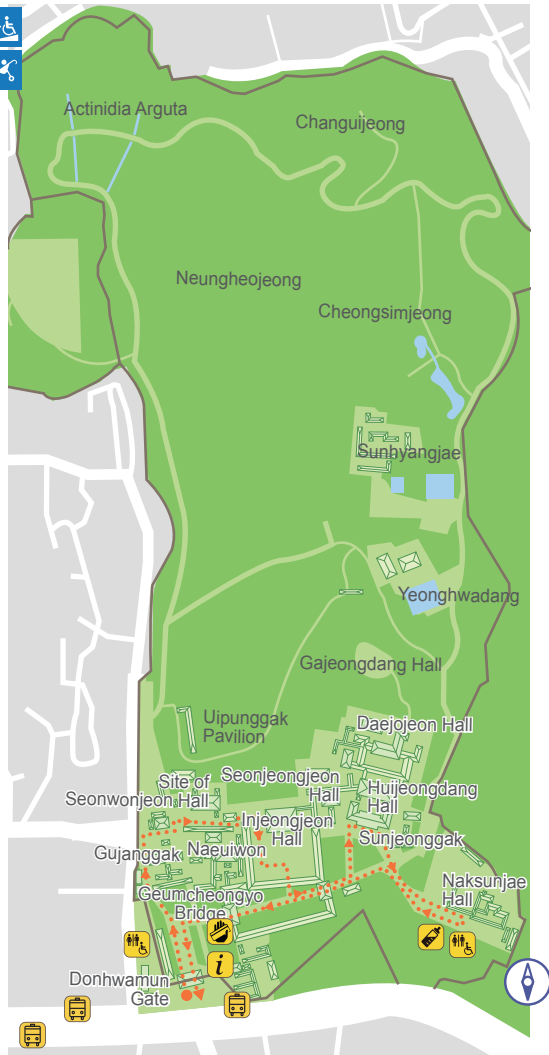

9 Jongmyo Shrine



Public Transportation

Take the subway to Jongno3(sam)-ga Station (Line1 & 5) and walk for 3 minutes from the elevator between exit No.12 and 13.



Facilities

Toilet for the disabled

Nearby Yeongnyeongjeon

Family toilet Inside the toilet

Diaper deck Inside the nursing room

Nursing room Next to the exit

Wheelchair rental Next to the nursing room exit

Stroller rental Next to the nursing room exit



Operating Hours

February - May, September - October 9:00~18:30

June - August 9:00~17:30

November - January 9:00~18:00

(Ticket office closes - 1 hour before closing)

* Free exploration available on Saturday & every last Wednesday

10 Changgyeonggung Palace



Public Transportation

Take a low floor bus at Exit No. 6, Anguk Station (Line 3) and walk for 7 minutes from the bus stop.
(Bus # 151, 172, 272, 171)

Facilities

Toilet for the disabled

Grand Greenhouse Area, parking lot, Myeongjeongjeon Hall Area

Family toilet All toilets except the one nearby Wolgeunmun Gate

Nursing room Next to Information Desk

Wheelchair rental Visitor Center

Stroller rental Visitor Center

Operating Hours

9:00~21:00 (Last entrance at 20:00)

* Closed on Mondays

Parking

KRW 1,500 every 30 mins

Additional fee

KRW 500 every 10 mins after 30 mins

* 80% off for the disabled drivers, men of national merit, and the patients who suffer from aftereffects of exposure to defoliants

11 National Children's Science Center



Public Transportation

Take the subway to Hyehwa Station (Line 4) and walk for 6 minutes from the elevator at Exit No. 3.

Facilities

Toilet for the disabled Next to the cafe (1F) / nearby Children Classroom (1F) / nearby Sangsang Playground (2F)

Family toilet All toilets

Diaper deck

Nursing room and all toilets

Nursing room

Next to the elevator (1F)

Wheelchair rental

Information Desk (1F)

Stroller rental Information Desk (1F)

Operating Hours

9:30~17:30 (Last entrance at 16:30)

* Closed on Mondays, January 1st, Lunar New Year's Day & Chuseok

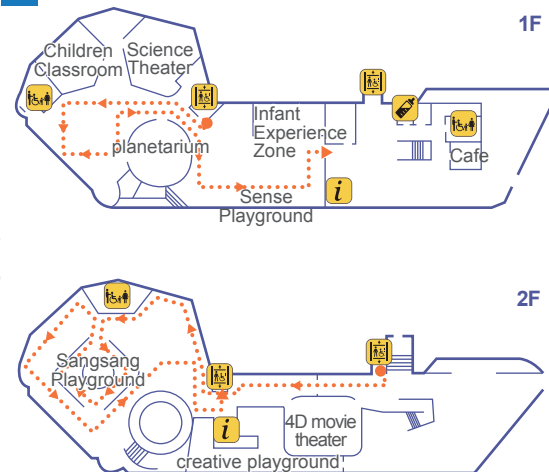

12 Marronnier Park



Public Transportation

Take the subway to Hyehwa Station (Line 4) and walk for 2 minutes from the elevator at Exit No. 3.

Facilities

Toilet for the disabled Inside Cafe

Diaper deck Inside toilet

Operating Hours

Always open



13 Seoul Metropolitan Library



Public Transportation

Take the subway to City Hall Station (Line 1 & 2) and walk for 5 minutes from the elevator at Exit No. 2. Use the Back Gate of the library

Facilities

Toilet for the disabled

Located on every floor

Family toilet

Next to Children's data section (1F)

Diaper deck Inside nursing room

Nursing room

Next to Children's data section (1F)

Wheelchair rental

Disability Collections

Stroller parking

Next to Children's data section (1F)

Operating Hours

Tuesday - Friday 9:00~18:00

(Last entrance at 17:00)

Saturday - Sunday 9:00~17:00

(Last entrance at 16:00)

Weekends & Holidays 9:00~19:00

P Parking

KRW 1,000 every 10 mins

* 80% off for the disabled drivers, men of national merit, and the patients who suffer from aftereffects of exposure to defoliants

* 50% off for compact cars, low-emission cars, and Dadoongee card holders, etc.

* Vehicles are not allowed on every 4th Wednesday for Public Transportation's Day (except for the disabled)

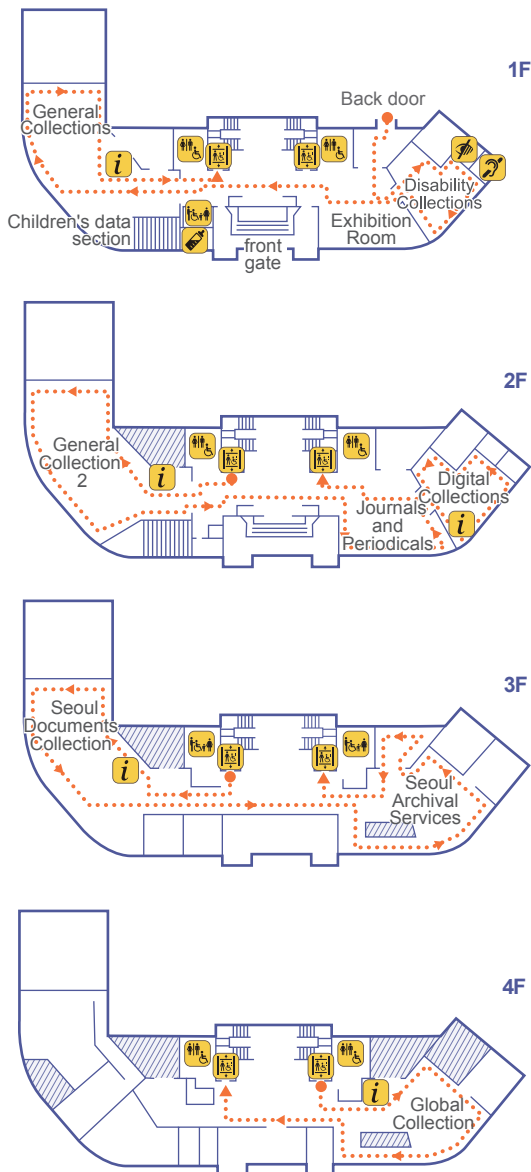

14 Deoksugung Palace



Public Transportation

Take the subway to City Hall Station (Line 1 & 2) and walk for 2 minutes from the elevator at Exit No. 2.

Facilities

Toilet for the disabled

Next to Deoksugung Hall of National Museum of Modern and Contemporary Art Seoul, and Jeongwanheon

Diaper deck Inside nursing room

Nursing room

Next to the toilet nearby Deoksugung Hall of National Museum of Modern and Contemporary Art Seoul

Wheelchair rental

Information Desk

Stroller rental Information Desk

Stroller parking Information Desk

Operating Hours

9:00~21:00

(Ticket office closes at 20:00)

* Closed on Mondays

15 Seoul Museum of Art



Public Transportation

Take the subway to City Hall Station (Line 1 & 2) and walk for 10 minutes from the elevator at Exit No. 9.

Facilities

Toilet for the disabled

Inside family toilet (women's) (1F)
Inside toilet (men's) (1F)

Family toilet

1F Right side the main gate (men's & women's)
2F Right side from the central staircase (women's)
3F Right side from Crystal Gallery (women's)

Diaper deck Nursing room (1F) family toilet (men's & women's), women's family toilet (2F), women's family toilet (3F)

Nursing room

Inside Children's playroom

Wheelchair rental

Inside Children's playroom

Stroller rental Inside Children's playroom

Stroller parking

Inside Children's playroom

Operating Hours

March - October

(Weekdays) 10:00~20:00

March - October

(Weekends & Holidays) 10:00~19:00

November - February

(Weekdays) 10:00~20:00

November - February

(Weekends & Holidays) 10:00~18:00

(Last entrance - 1 hour before)

* Closed on Mondays & January 1st

P Parking

Open 6:00~23:00

Mon~Fri KRW 400 every 5 mins

Weekends & Holidays

KRW 300 every 5 mins

* 80% off for the disabled drivers, men of national merit, and the patients who suffer from aftereffects of exposure to defoliants

* 30~50% off for compact cars, low-emission cars, and Dadoongee card holders, etc.

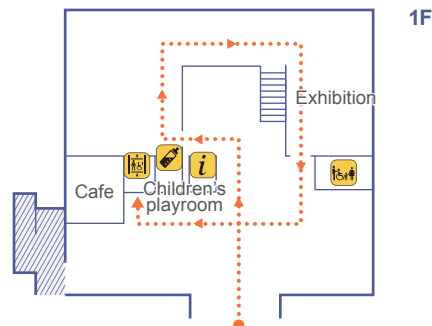

1F

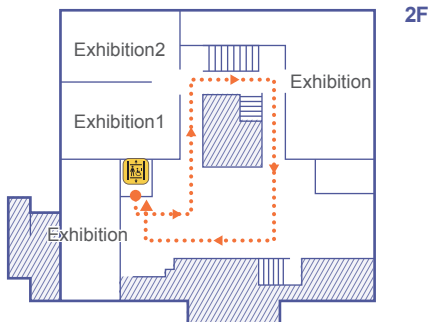

2F

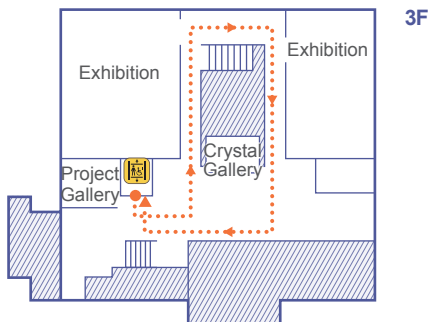

3F

16 Seoul Animation Center



ANI PICNIC 2F

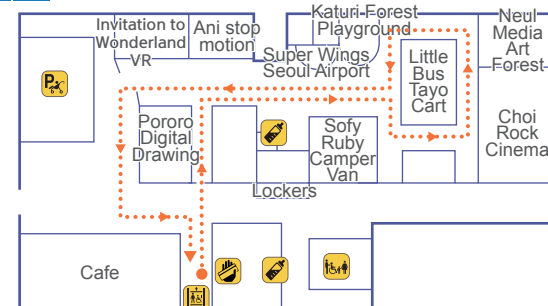

Public Transportation

Take the subway to Hoehyeon Station (Line 4) and walk for 10 minutes from the elevator at Exit No. 3.

Operating Hours

1F Comics Cafe 10:00~18:00

2F Ani Picnic 10:00~18:00

(Ticket office closes at 17:00)

* Closed on Mondays and center-designated other dates

Facilities

Toilet for the disabled

1F, Woori Finance Namsan Tower

Family toilet Ani Picnic (2F)

Diaper deck Inside the nursing room

Nursing room

Next to women's room, Next to the Sofy Ruby Camper Van (2F)

Stroller parking

In front of the exit of Ani Picnic (2F)

Seats (Performance facility) Ani Picnic (2F)

17 Seoulo 7017



Public Transportation

Take the subway to Seoul Station (Line 1 & 4) and walk for 2 minutes from the elevator at Exit No. 2.

Operating Hours

Always open

P Parking

Parking at Seoulo Terrace

KRW 2,000 for 30 mins / KRW 4,000 per hr / KRW 8,000 for 2 hrs / Free for 4 hours on weekends and holidays

18 Culture Station Seoul 284

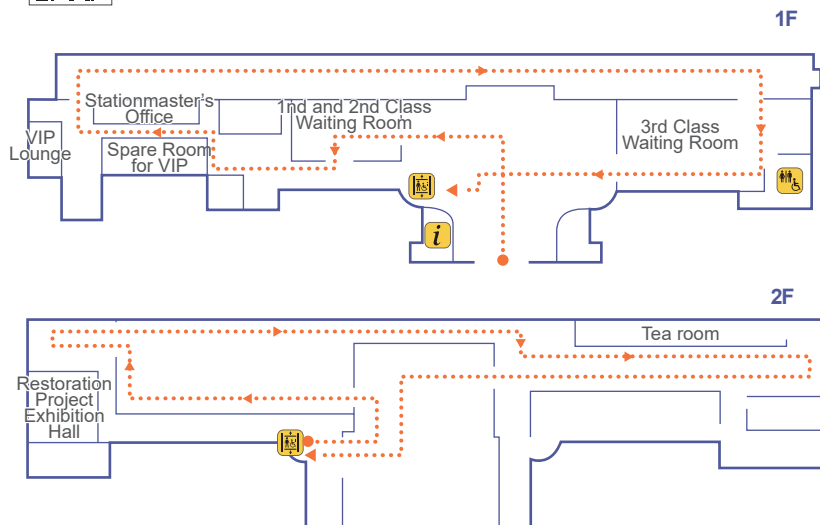

Public Transportation

Take the subway to Seoul Station (Line 1 & 4) and walk for a minute from the elevator at Exit No. 1.



Facilities

Toilet for the disabled
Building No. 3 Waiting room (1F)
Wheelchair rental Information Desk



Operating Hours

10:00~19:00
(Closing 30 minutes before)
*Open until 9:00 pm every last Wednesday to celebrate Culture Day / Closed on Mondays

19 Kim Koo Museum & Library

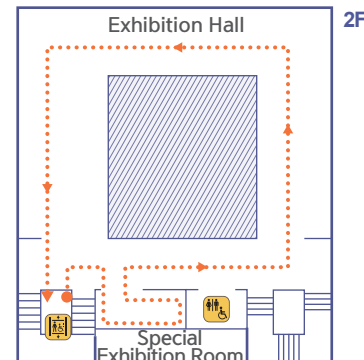
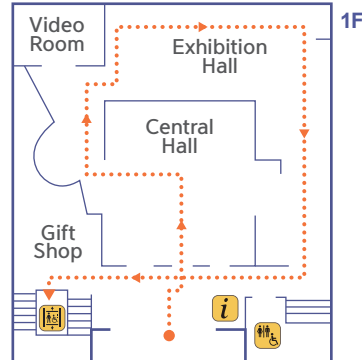

Public Transportation

Take the subway to Hyochang Park Station (Line 6) and walk for 12 minutes toward Hyochang Stadium from the elevator at Exit No. 4.



Facilities

Toilet for the disabled
Next to Information Desk (1F), next to Special Exhibition Hall (2F)
Wheelchair rental Information Desk
Stroller rental Information Desk



Operating Hours

March - October 10:00~18:00
(Last entrance at 17:00)
November - February 10:00~17:00
(Last entrance at 16:00)
* Closed on Mondays, January 1st, Lunar New Year's Day & Chuseok

P Parking

KRW 300 every 10 mins
(Free for the first 10 mins)
* 50 % off for the disabled drivers, men of national merit, and compart cars

20 Crown Haitai Kids Museum



Public Transportation

Take the subway to Namyeong Station (Line 1) and walk for 5 minutes from the elevator at Exit No. 1. Take the elevator to the B1 floor.



Facilities

Toilet for the disabled
Next to the Information Desk of Crown Haitai Headquarter building (1F)
Family toilet Separate toilet for kids inside Kids Museum
Diaper deck
Inside the toilet of Crown Haitai Headquarter building (1F)
Stroller parking
Both sides of Creative Experience Class



Operating Hours

Sangsang Playground 10:00~17:00
Creative Experience Class 11:00 / 14:00 / 15:00
* Closed on Mondays

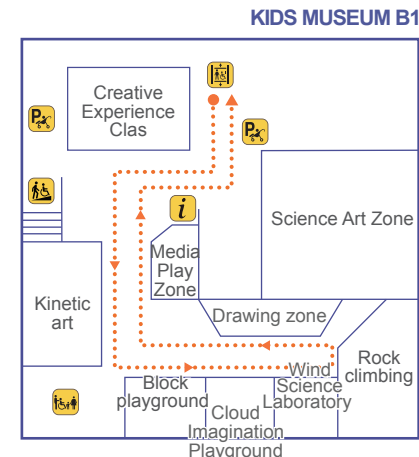

21 The War Memorial of Korea



Public Transportation

Take the subway to Samgakji Station (Line 4 & 6) and walk for 6 minutes from the elevator at Exit No. 12.

Facilities

Toilet for the disabled (1F)

Inside women's family toilet next to The War History Room I (women's)
Inside women's family toilet next to Large Industries Equipment Room (women's)

Toilet for the disabled (2F)

Outside men's toilet in front of the nursing room (men's)
Inside women's toilet next to The Korea War Room I (women's)

Toilet for the disabled (3F)

Inside women's family toilet next to UN Room (women's)
Inside men's toilet next to THE ROK Armed Forces Room (men's)

Family toilet

Next to The War History Room I (women's) (1F), next to Large Industries Equipment Room (women's) (1F), next to UN Room (women's) (3F)

Diaper deck

Inside nursing room (2F)

Nursing room

In front of Cafe (2F)

Wheelchair rental

Information Desk (2F)

Stroller rental

Information Desk (2F)

Operating Hours

9:30~18:00

(Last entrance - 30 minutes before)

* Closed on Mondays (Note that if the public holiday is Monday, the memorial will be closed on the next day after the holiday)

Parking

Compact car

(less than 15 passengers)

KRW 3,000 for less than 2 hrs /

Additional fee KRW 1,000 every 30mins

Full-sized car

(more than 16 passengers)

KRW 10,000 for less than 2 hrs /

Additional fee KRW 3,000 every 30mins

* Free for the men of national merit

* 50% off for the disabled drivers

/ compact cars / electric cars /

Dadoongee card holders.

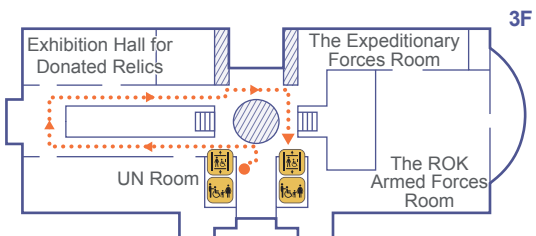
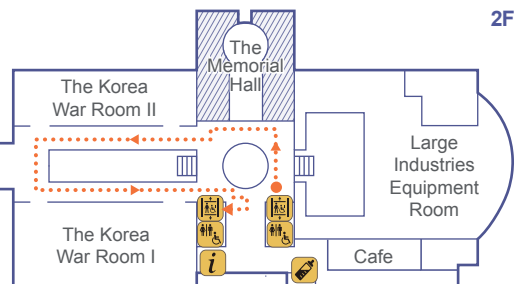
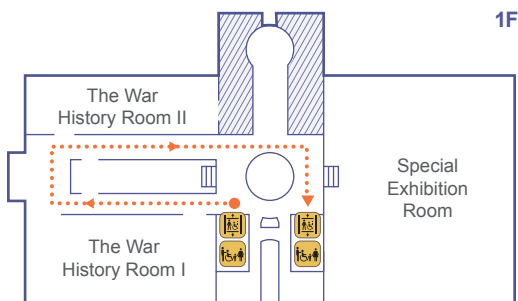

22 Namsan Cable Car



Public Transportation

Take the subway to Hoehyeon Station (Line 4) and walk for 15 minutes from the elevator at Exit No. 7.

Facilities

Toilet for the disabled

Women's room (1F), Men's room (2F)

Family toilet

Inside the toilet for the disabled (2F),

cable car platform

Diaper deck

Toilet for the disabled and nursing room (2F)

Nursing room

Next to the Diaper deck (2F)

Wheelchair rental

Ticket booth

Operating Hours

10:00~22:00 (Subject to be extended on Friday, Saturday, and holidays)

* Always open

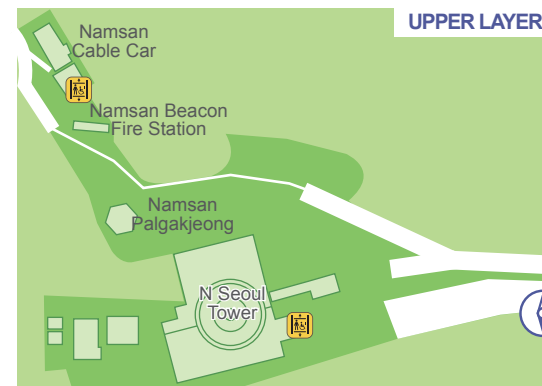
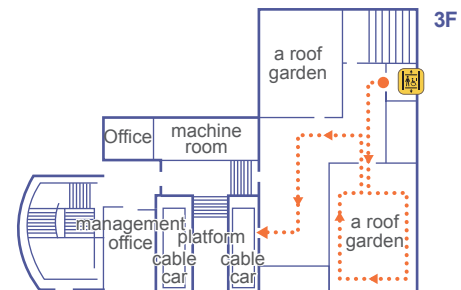
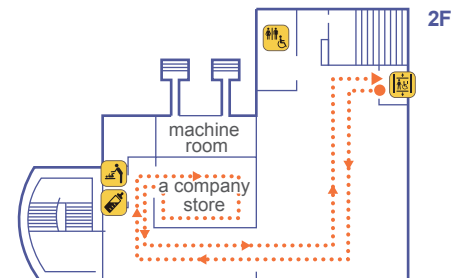
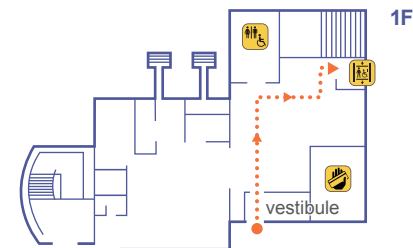

23 N Seoul Tower



Public Transportation

Take Namsan Cable Car / Bus / City bus / your vehicle / or walk along the park.

Facilities

Toilet for the disabled

Left of Information Desk (5F)

Family toilet

Combined use with toilet for the disabled

Diaper deck

Toilet for the disabled, nursing room

Nursing room Right of Information Desk (5F)

Wheelchair rental Information Desk (5F)

Stroller rental Information Desk (5F)

Stroller parking Contact Information Desk

Operating Hours

Weekdays 12:00~22:00

Weekends & Holidays 11:00~22:00

* Always open

Parking

KRW 1,000 every 10 mins

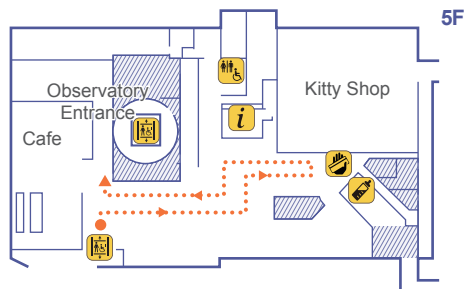
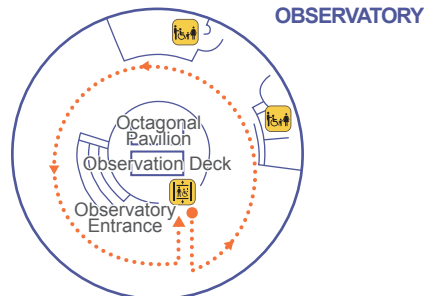

24 Namsangol Hanok Village



Public Transportation

Take the subway to Chungmuro Station (Line 3 & 4) and walk for 5 minutes from the elevator at Exit No. 7.

Facilities

Toilet for the disabled

Toilet nearby main gate, The Seoul Namsan Gukakdang

Family toilet Inside the toilet for the disabled

Diaper deck Inside the family toilet

Nursing room Information Desk at the main gate

Wheelchair rental Management office

Stroller rental Management office

Operating Hours

April - October 9:00~21:00

November - March 9:00~20:00

Traditional Garden Always open * Closed on Mondays

Parking

Seoul Public Parking

KRW 3,000 per hr (space for 14 compact cars, 3 midsize cars)

Parking at Dongguk University Media Center

KRW 6,000 per hr (99 vehicles)

Parking at Gukakdang Free

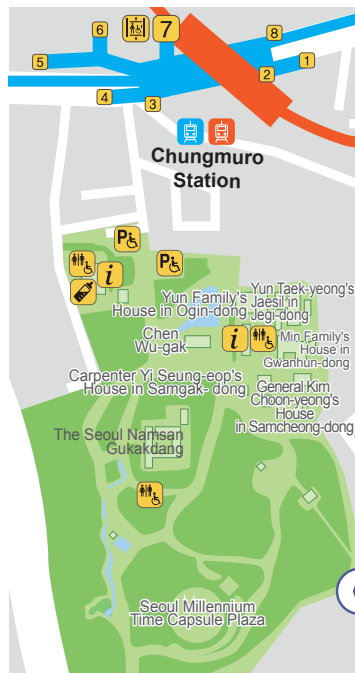

25 Nodeulseom Island



Public Transportation

Take the subway to Nodeul Station (Line 9) and walk for 16 minutes from the elevator at Exit No. 3.

Facilities

Toilet for the disabled

Nearby Music Lounge

Family toilet

Kid's toilet located inside the toilet

Diaper deck Family toilet, nursing room

Nursing room

Next to the toilet for the disabled

Operating Hours

Outdoor Always open

Indoor 11:00~22:00

* Indoor facilities - Closed on Mondays

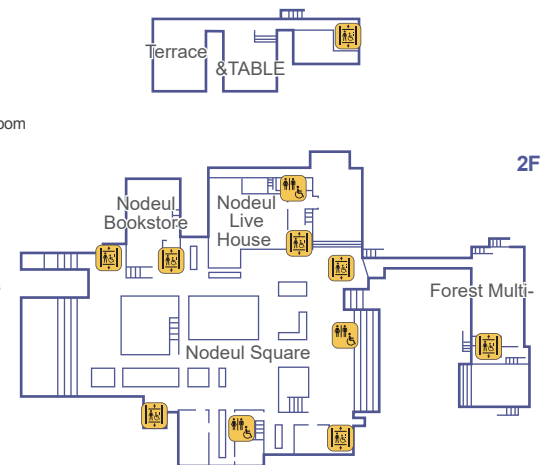
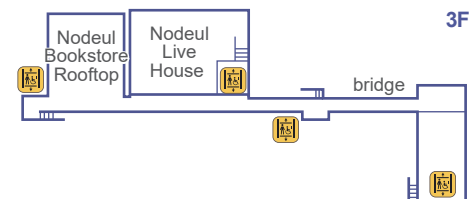

OUTDOOR SPACE / 1F



26 National Museum of Korea

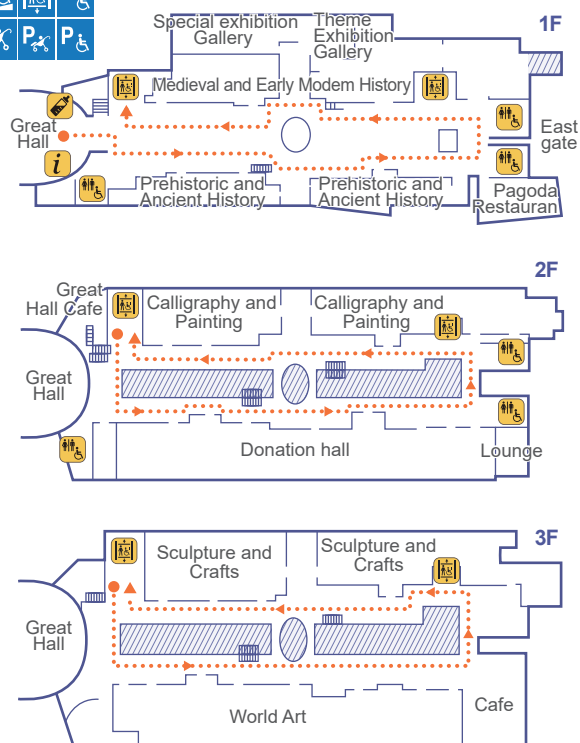

Public Transportation

Take the subway to Ichon Station (Line 4) and walk along Museum Nadeulgil (underground path). Take the elevator to the 2nd floor.

Facilities

Toilet for the disabled

At the end of the right-side hallway, next to the Great Hall entrance (1F, 2F)

Family toilet

Inside all toilets, inside the nursing room

Nursing room

Next to the rental shop (1F)

Wheelchair rental

Rental shop (1F)

Stroller rental

Storage room (1F)

Operating Hours

Monday, Tuesday, Thursday & Friday

10:00~18:00

Wednesday & Saturday 10:00~21:00

Sunday & Holidays 10:00~19:00

* Closed on January 1st, Lunar New Year's Day & Chuseok, and 1st Monday every April and November.

P Parking

Compact car

Minimum KRW 2,000 for 2 hrs

Additional fee

KRW 500 every 30 mins after 2 hrs

Mid/full-sized car

Minimum KRW 4,000 for 2 hrs

Additional fee

KRW 1,000 every 30 mins after 2 hrs

*Free for the disabled drivers and men of national merit

27 National Hangeul Museum



Public Transportation

Take the subway to Ichon Station (Line 4) and walk for 10 minutes from the elevator at Exit No. 2.

Facilities

Toilet for the disabled

Located on every floor

Diaper deck

Inside toilet

Nursing room

Next to Hangeul Learning Center (3F)

Wheelchair rental

1F, 2F

Stroller rental

1F, 2F

Operating Hours

10:00~18:00

Saturday & Culture Day

(Every last Wednesday)

10:00~21:00

* Closed on January 1st, Lunar New Year's Day & Chuseok

P Parking

Compact car

Minimum KRW 3,000 for 2 hrs

Additional fee

KRW 800 every 10 mins after 2 hrs

Mid/full-sized car

Minimum KRW 5,000 for 2 hrs

Additional fee

KRW 800 every 10 mins after 2 hrs

* Free for the disabled drivers and men of national merit

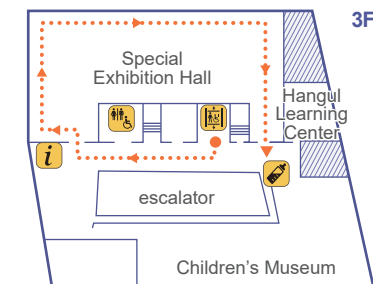
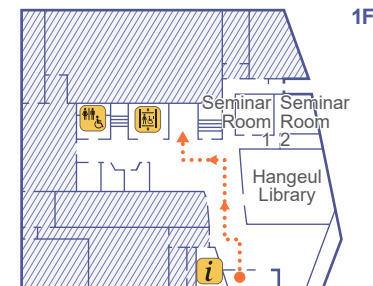

28 Yongsan Park

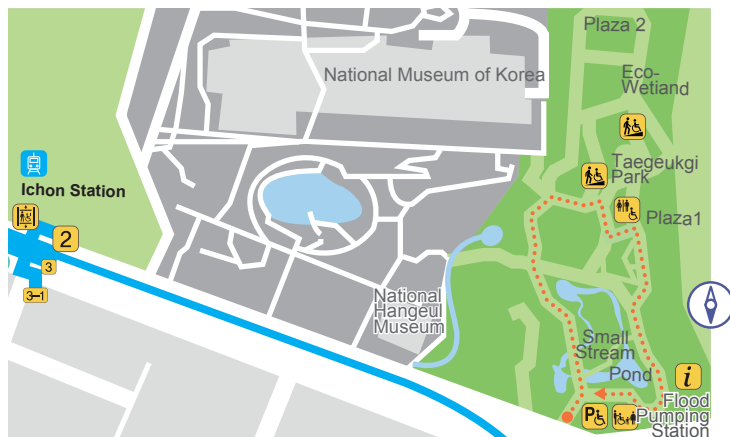

Public Transportation

Take the subway to Ichon Station (Line 4) and walk for 10 minutes from the elevator at Exit No. 2.

Facilities

Toilet for the disabled Next to the entrance, next to the Kids Playground
Family toilet Toilet next to the entrance
Diaper deck Toilet for the disabled
Wheelchair rental Information Desk
Stroller rental Information Desk

Operating Hours

Always open

Parking

KRW 300 every 10 mins
 * 80% off for the disabled drivers

29 Dooly Museum



Public Transportation

Take the subway to Ssangmun Station (Line 4) and walk for 15 minutes from the elevator between exit No. 1 and 2.

Facilities

Toilet for the disabled Museum building (1F), Library building (1F)
Family toilet Located in every toilet
Diaper deck Nursing room, women's rooms
Nursing room Next to the toilet (1F)
Seats (Performance facility) Theater (B1F)

Operating Hours

10:00~18:00 (Last entrance at 16:20)
 * Closed on Mondays, January 1st,
 Lunar New Year's Day & Chuseok

LIBRARY BUILDING 1F

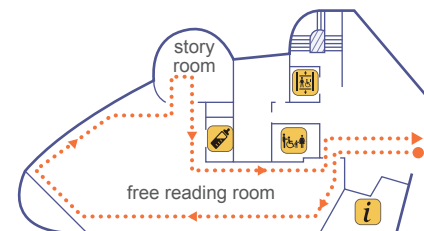

MUSEUM BUILDING B1

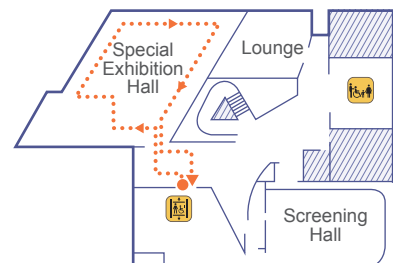

MUSEUM BUILDING 1F

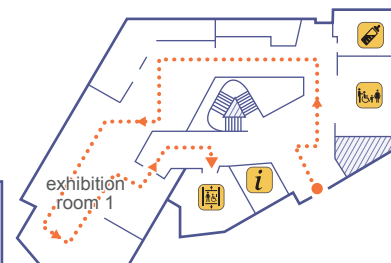

MUSEUM BUILDING 2F

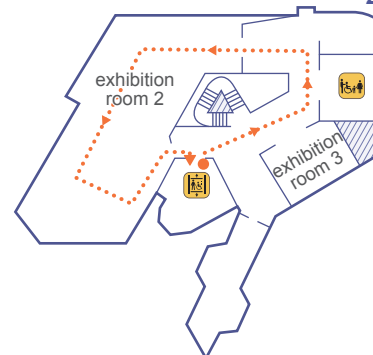

MUSEUM BUILDING 3F



30 Dream Forest

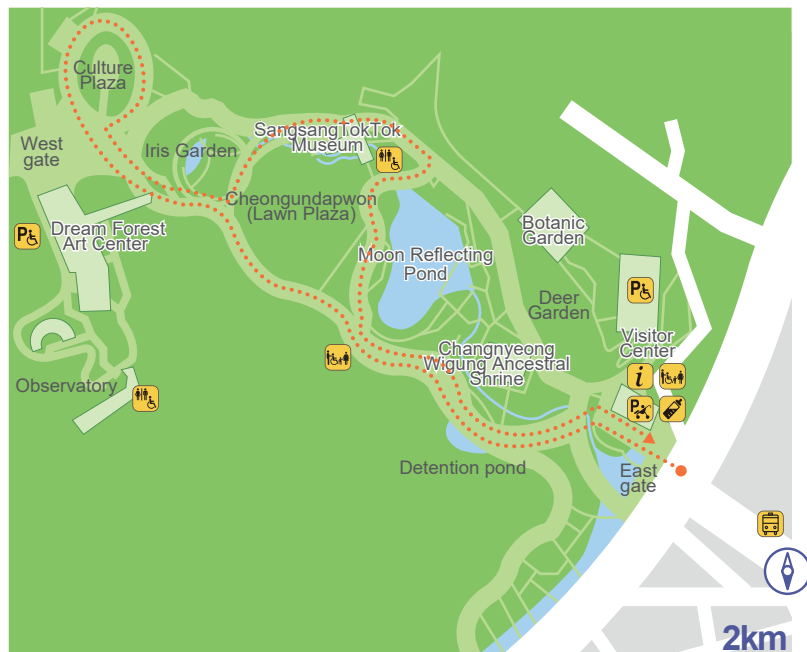

Public Transportation

Take a low floor bus #147 at Exit No. 3, Dolgoji Station (Line 6) to Dream Forest Station.

Facilities

Toilet for the disabled
Moon Reflecting Pond, Visitot Center, Sangsang TokTok Museum
Family toilet
Moon Reflecting Pond, Visitot Center
Diaper deck
Family toilet, Nursing room
Nursing room Visitot Center
Wheelchair rental Visitot Center
Stroller rental Visitot Center

Operating Hours

Outdoor Always open
Sangsang TokTok Museum 10:00~18:00
Visitors Center 9:00~18:00
Observatory 10:00~22:00
* Sangsang TokTok Museum, Visitors Center, Observatory - Closed on Mondays

Parking

Parking at East gate and West gate
KRW 300 every 10 mins
* 80% off for the disabled drivers

31 Seoul Science Center



Public Transportation

Take the subway to Hagye Station (Line 7) and walk for 20 minutes from the elevator at Exit No. 6.

Facilities

Toilet for the disabled
Inside toilet (1F)
Diaper deck
Inside toilet, Inside Nursing room
Nursing room
Right of Information Desk (1F)
Wheelchair rental
Information Desk
Stroller rental Information Desk
Stroller parking 1F, 2F

Operating Hours

9:30~17:30
* Closed on Mondays (If the public holiday is Monday, the center will be closed on Tuesday), January 1st, Lunar New Year's Day & Chuseok

Parking

KRW 150 every 5 mins

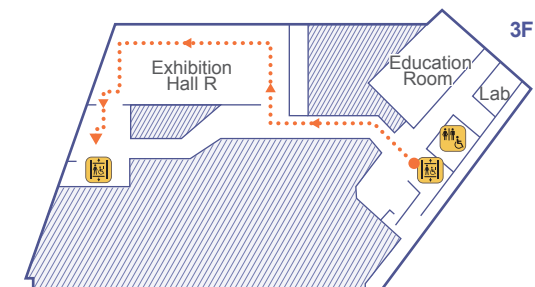
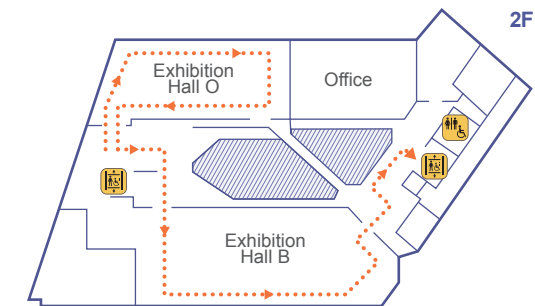
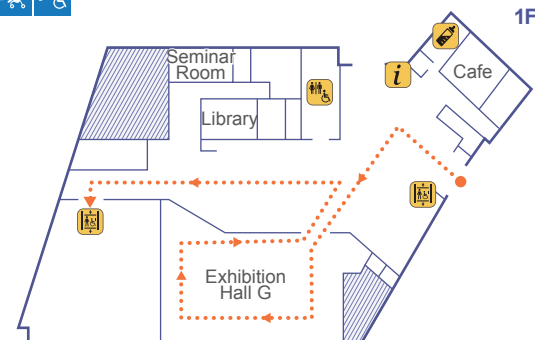

32 Buramsan Butterfly Garden



Public Transportation

Take the subway to Sanggye Station (Line 4) and walk for 15 minutes from the elevator at Exit No. 1.

Facilities

Family toilet
Inside Butterfly Garden, Eco Experience Center
Diaper deck
Inside the toilet for the disabled
Nursing room
Inside Butterfly Garden

Operating Hours

Outdoor Always open
Indoor 10:00~17:00
(Last entrance - 16:30)
*Closed on Mondays,
Lunar New Year's Day
& Chuseok



1F

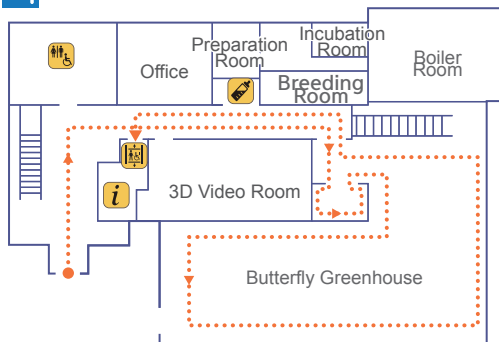

2F

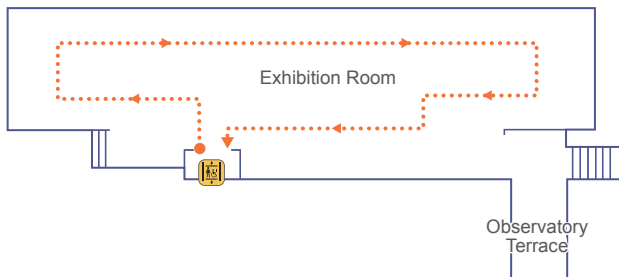

OUTDOOR

33 Savina Museum of Contemporary Art



Public Transportation

Take the subway to Dokbawi Station (Line 6) and take an elevator at Exit No. 1. Take bus #7720 at the bus stop across the road to Sindo Elementary and Middle school. Walk for 3 minutes.

Facilities

Toilet for the disabled
Next to the elevator (3F)
Stroller parking Information Desk

Operating Hours

10:00~18:00 (Last entrance - 17:00)
* Closed on Mondays

P Parking

Free

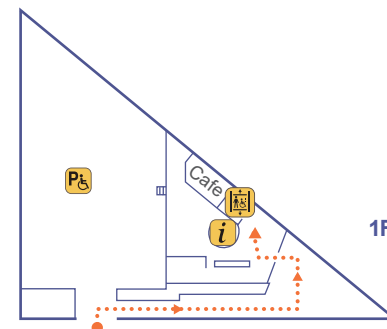

1F

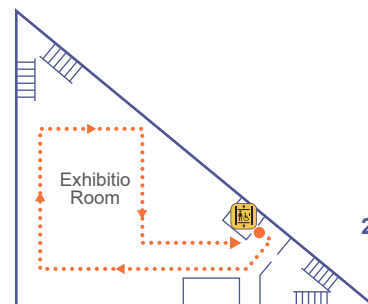

2F

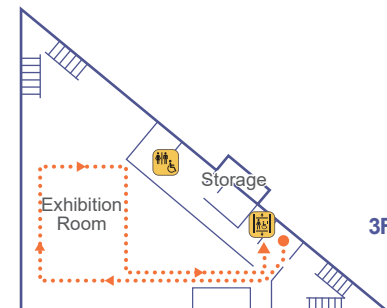

3F

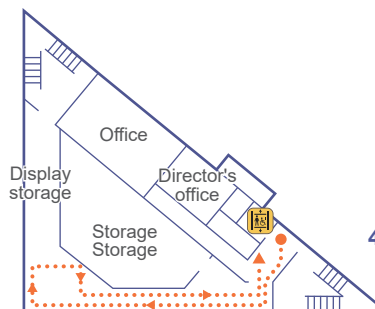

4F

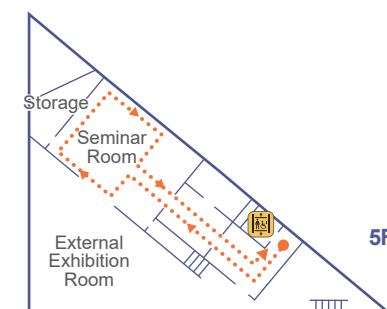

5F

PART.2
GANGNAM

34 Hyundai Motor Studio Seoul



Public Transportation

Take the subway to Apgujeong Rodeo Station (Suin Bundang Line) and take a low floor bus #145 at Exit No. 7 elevator. 13 minutes away by bus.

Facilities

Toilet for the disabled Toilet (2F)

Family toilet Toilet (2F)

Diaper deck Toilet (2F)

Operating Hours

9:00~21:00

* Closed every 1st Monday, January
1st, Lunar New Year's Day & Chuseok

Parking

Free for the first 2 hrs

Additional fee
KRW 1,000 every 10 mins
after 2 hrs

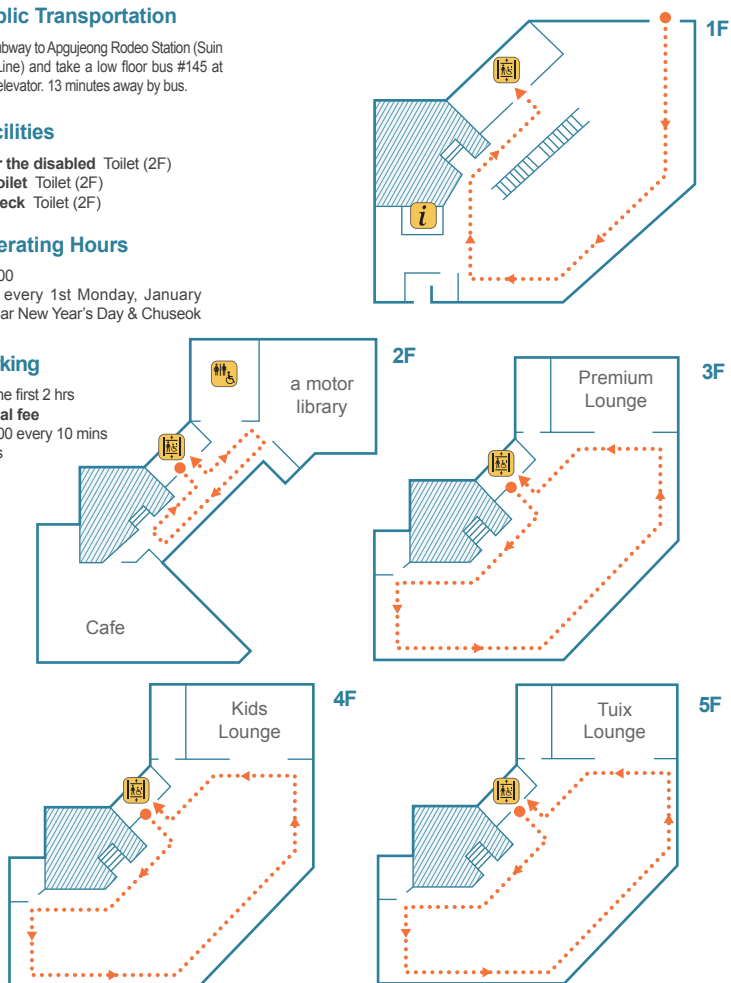

35 Seolleung and Jeongneung Royal Tombs



Public Transportation

Take the subway to Seolleung Station (Line 2 & Suin Bundang Line) and walk for 6 minutes from the elevator at Exit No. 10.

Facilities

Toilet for the disabled
Toward Jeongneung from the entrance,
Next to the History Culture

Wheelchair rental
Across from ticket booth

Stroller rental
Across from ticket booth

Operating Hours

March - October 6:00~21:00
November - January 6:30~17:30
February 6:00 ~ 18:00

(Last entrance - 1 hour before)
* Closed on Mondays

Parking

KRW 400 every 5 for the first 2 hrs
Additional fee

KRW 600 every 5 mins after 2 hrs
* 80% off for the disabled drivers and
men of national merit
* 50% off for compact cars, low-
emission cars

36 COEX



COEX STARFIELD MALL B1

Public Transportation

Take the subway to Samseong Station (Line 2) and take a lift located between exit No. 5 and 6. Take another elevator on the right facing the front, and walk for a minute.

Facilities

Toilet for the disabled (1F)

Entrance of path to the Parking Customer Center, Behind Devil's Door

Toilet for the disabled (2F)

East of Asem Ballroom, West of ASEM Ballroom

Toilet for the disabled (3F)

East of Auditorium, West of Auditorium, in front of Conference room 303, nearby Conference room E

Toilet for the disabled (COEX Starfield Mall B1)

next to Byeol-Madang Library, next to Mega Box entrance

Nursing room

Inside COEX Mall (B1F)

Wheelchair rental

East Gate Information Desk, COEX (1F)
Safe Control Room next to West Gate

Stroller rental

COEX Mall, next to Mega Box entrance, Starfield COEX Mall, between LATEM and Swatch stores

Operating Hours

10:00~22:00 *Always open

Parking

Free for the first 20 mins

Additional fee

KRW 1,200 every 15 mins after 20 mins
* 50% off for the disabled drivers and men of national merit

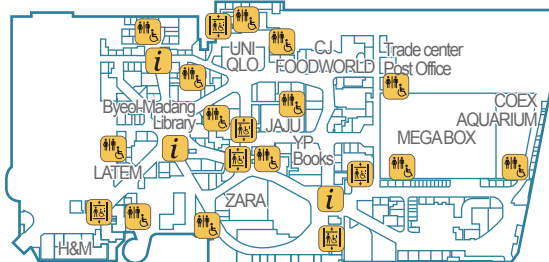

1F

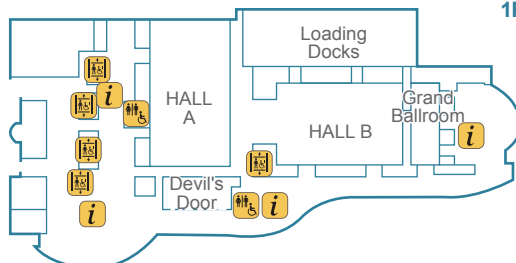

2F

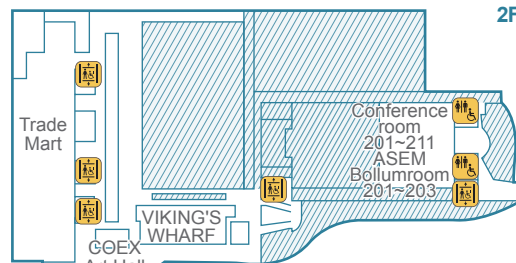

3F

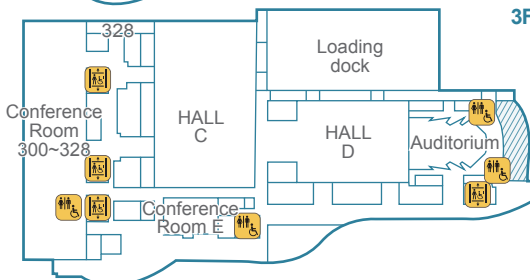

37 Boramae Park



Public Transportation

Take the subway to Sindaeabang Station (Line 2) and walk for 5 minutes from the elevator at Exit No. 2

Facilities

Toilet for the disabled

Next to Jang Mi-won Pond, Playground toilet, In front of the Multi-purpose playground, Next to Boramae Youth Training Center

Family toilet

Combined use with toilet for the disabled

Diaper deck

Inside the nursing room, inside every toilet

Nursing room

Management office of Boramae Park

Wheelchair rental

Inside the nursing room

Stroller rental

Inside nursing room

Operating Hours

Always open

Parking

Operating Hours 9:00~22:00

Compact car KRW 100 every 5 mins

Full-sized car KRW 300 every 5 mins

* 80% off for the disabled drivers

38 Gwanaksan Mountain Nakseongdae Park



Public Transportation

Take the subway to Nakseongdae Station (Line 2) and walk for 15 minutes from the elevator at Exit No. 6.

Facilities

Toilet for the disabled

Next to Management office

Family toilet

Next to Management office

Diaper deck

Inside nursing room

Nursing room

Next to Cafe

Wheelchair rental

Management office

Operating Hours

Always open

Parking

Free

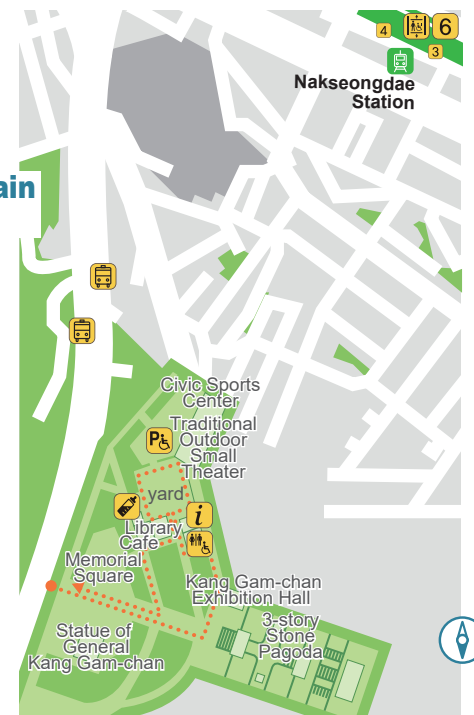

39 Seoul National Cemetery



Public Transportation

Take the subway to Dongjak Station (Line 4 & 9) and take an elevator between exit No. 7 and 8. Walk for a minute.

Facilities

Toilet for the disabled Next to family toilet, next to the President Park Chung-hee's tomb, nearby Hyeonchungwan Memorial Hall
Family toilet
Diaper deck Nursing room, inside the toilet for the disabled next to the President Park Chung-hee's tomb, inside the toilet for the disabled nearby Hyeonchungwan Memorial Hall
Nursing room Customer Office of General Service Office, nearby Hyeonchungwan Memorial Hall
Wheelchair rental General Service Office
Stroller rental General Service Office
Stroller parking General Service Office

Operating Hours

Opening hours of Cemetery 6:00~18:00
 (5 places including main gate, East Gate, Tongmun Gate)
Opening hours of business facilities 9:00~18:00 (Business facilities: Management office, General Service Office, Chunghondang, Patriotic Exhibit Hall, Relics Exhibit Hall, Hyeonchungwan Memorial Hall, etc.)
 * Exhibition halls closed on holidays in November and Saturday & Holidays from December to February.

Parking

Free

40 Seoul Arts Center Opera House



Public Transportation

Take the subway to Nambu Bus Terminal Station (Line 3) and take a low floor bus #406 at Exit No. 5 elevator. Get off at the Seoul Arts Center Station and walk for a minute.

Facilities

Toilet for the disabled
 Toilet across from 1011 Children's Lounge
Family toilet
 Toilet across from 1011 Children's Lounge
Diaper deck Nursing room, toilets in the 1011 Children's Lounge (B1F)
Nursing room Hangaram Art Museum (1F)
Wheelchair rental Hangaram Art Museum (1F), Hangaram Design Museum (1F)
Stroller rental Hangaram Art Museum (1F), Hangaram Design Museum (1F)
Stroller parking In front of 1011 Children's Lounge, entrance of each exhibition hall

Operating Hours

Service Plaza 9:00~20:00
Hangaram Art Museum 10:00~19:00 (Closed on Mondays)

Parking

General visitors KRW 1,000 every 15 mins
Concert or performance ticket holders KRW 6,000 for 5 hrs
Exhibition ticket holders KRW 4,000 for 3 hrs
Facilities (cafe, shops) KRW 3,000 for 2 hrs
Multipurpose visitors KRW 10,000 for 12 hrs
 * Free for the first 30 mins / Disabled with grade 1~3: Free / Disabled with grade 4 and below: Free upon attending performance or exhibition (5 hrs / 3 hrs)

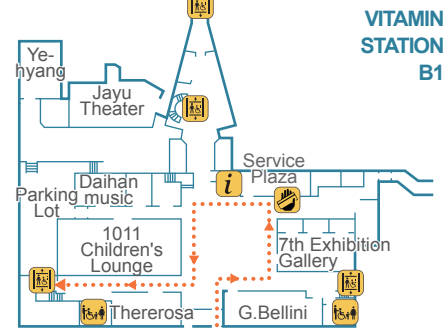
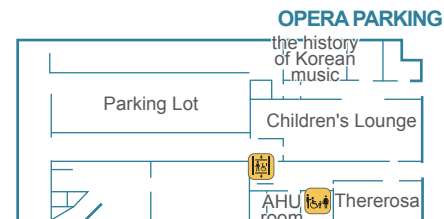

HANGARAM 1F

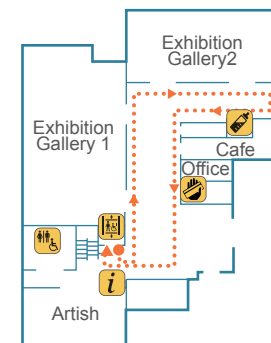

HANGARAM 2F

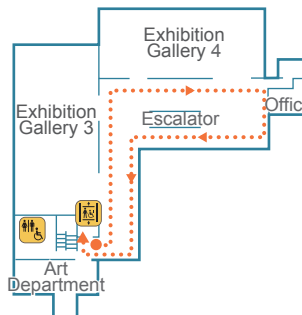

HANGARAM 3F

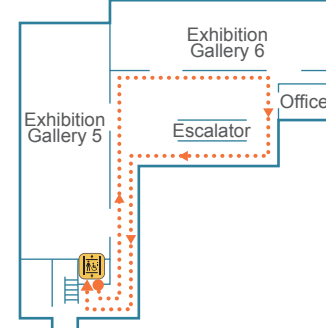

PART.3 GANGDONG

41 Lotte World Aquarium



Public Transportation

Take the subway to Jamsil Station (Line 2 & 8) and take an elevator to Exit No. 1, B1 floor.

Facilities

Toilet for the disabled

Next to Life Zone (B1F)

Family toilet

Kids toilet in all toilets

Diaper deck

All toilets & nursing room

Nursing room Toddler Lounge located between Coral Reef Garden and Play Ocean (B1F)

Wheelchair rental

Information Desk at the entrance

Stroller rental

Information Desk of Lotte World Mall (4F)

Stroller parking

Information Desk at the exit

Operating Hours

Monday - Thursday

10:00~20:00 (Last entrance at 19:00)

Friday - Sunday

10:00~22:00 (Last entrance at 21:00)

* Always open

Parking

For visitors to Aquarium on the day

10:00~20:00

Maximum KRW 4,800 for 4 hrs

Additional fee

KRW 200 every 10 mins after 4 hrs

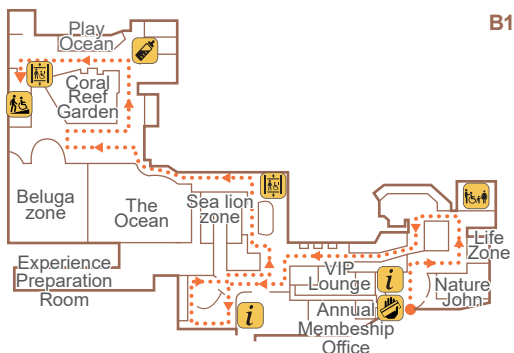

B1

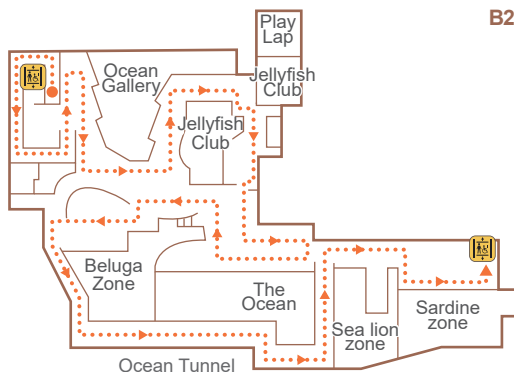

B2

42 Seoul Sky



Public Transportation

Take the subway to Jamsil Station (Line 2 & 8) and walk through the Lotte World Tower underground path next to Exit No. 1.

Facilities

Toilet for the disabled

Next to the nursing room (B1F)

Diaper deck

Toilet for the disabled (B1F, 117F), nursing room (B1F)

Nursing room

B1F

Stroller parking

Guide Facility (B1F)

Operating Hours

Sunday - Thursday 11:00~21:00

(Ticket office closes at 20:00)

Friday - Saturday & Holidays

11:00~22:00 (Ticket office closes at 21:00)

* Always open

P Parking

Offer a free parking coupon for observatory visitor on the day

Maximum KRW 4,800 for 4 hrs

(KRW 1,200 per hr)

* Regular parking fee will be charged after 4 hours

Regular parking fee

10:00~20:00 KRW 500 for 10 mins

Additional fee

KRW 200 every 10 mins after 10 mins

* Free parking coupon should be presented with a receipt at the exit.

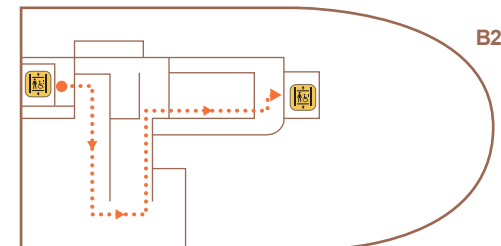

B2

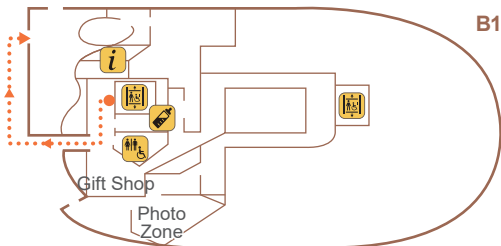

B1

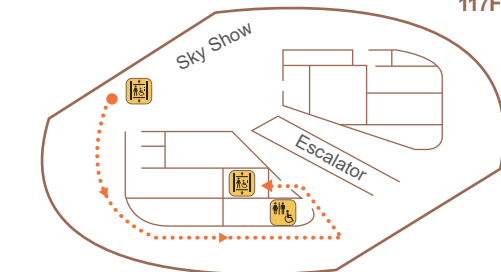

117F

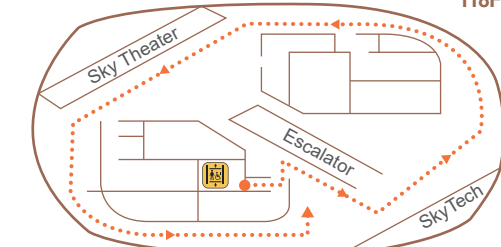

118F

43 Seoul Olympic Museum of Art



Public Transportation

Take the subway to Hanseong Baekje Station (Line 9) Exit No.2, walk through the underground path leading to Hall 2, B1 floor.

Facilities

Toilet for the disabled

In front of Exhibition Room 5, Museum 1 (1F), next to Exhibition Room 1, Museum 1 (2F)

Family toilet

Combined use with toilet for the disabled

Diaper deck

Family toilet

Nursing room

Next to Information Desk, Museum 2 (B1F)

Wheelchair rental

Information Desk

Stroller rental

Information Desk

Stroller parking

Information Desk

High chairs

Information Desk

10:00~18:00

* Closed on Mondays, January 1st,

Lunar New Year's Day & Chuseok

P Parking

Compact car

KRW 1,000 for 1 hrs

Additional fee

KRW 500 every 10 mins after 1 hr

Mid/full-sized car

Minimum KRW 5,000 for 2 hrs

Additional fee

KRW 800 every 10 mins after 2 hrs

* 50% off for the disabled drivers,

men of national merit, compact

cars, and low-emission cars

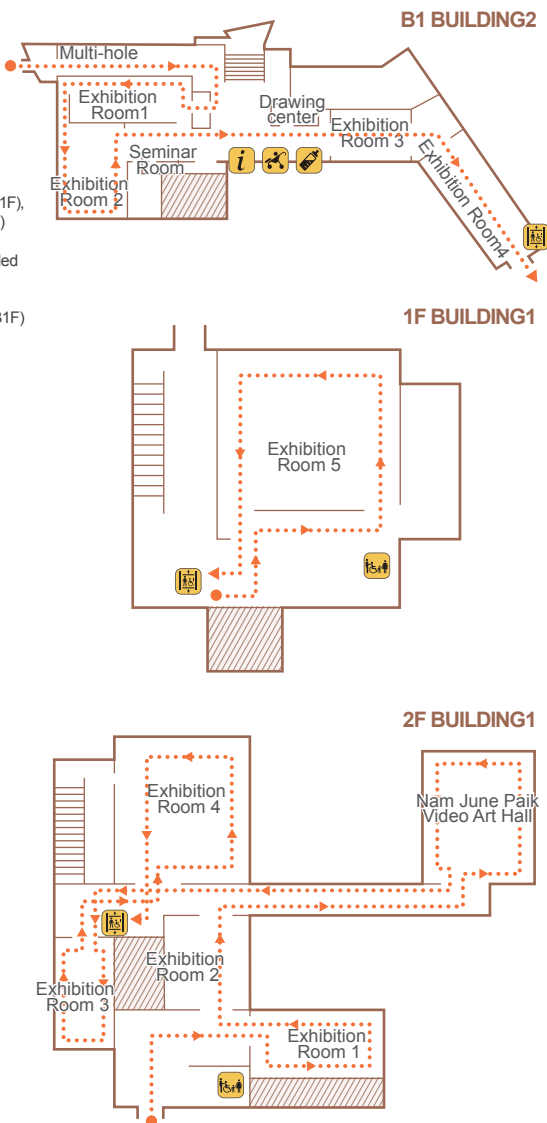

44 Mongchontoseong Fortress

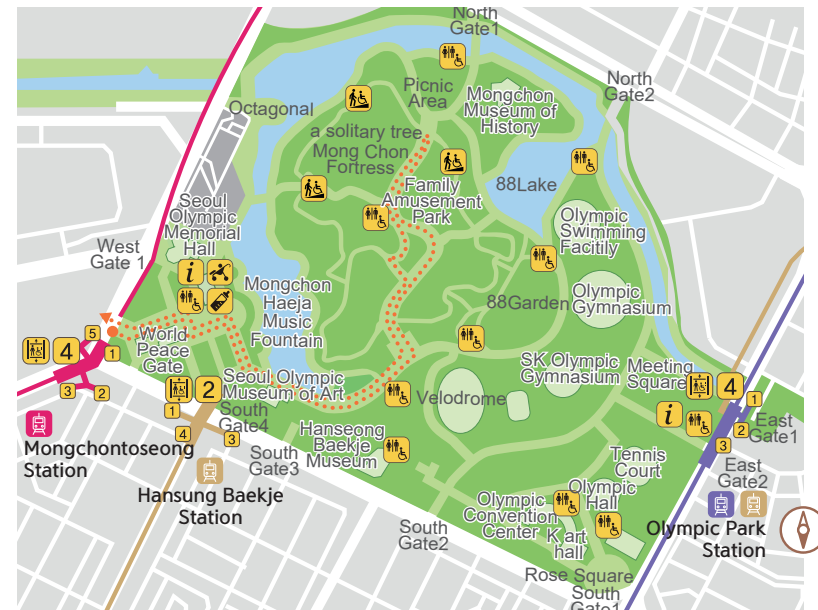

Public Transportation

Take the subway to Hanseong Baekje Station (Line 9) and walk for 15 minutes from the elevator at Exit No. 2.

Facilities

Toilet for the disabled

All toilets within the park

Family toilet

Mom & Babies' Room in women's room

Diaper deck

Nursing room

Nursing room

Information Desk

Wheelchair rental

Information Desk

Operating Hours

Mongchontoseong Fortress

5:00~22:00 Always open

Mongchon History Museum

9:00~18:00

* Closed on Saturdays & Sundays

P Parking

Operating Hours 6:00~24:00

Compact car KRW 1,000 for 1 hr

Additional fee

KRW 500 every 10 mins after 1 hr

Full-sized car (for more than 24

passengers, larger than 2.5 tons)

KRW 12,000

* 50% off for the disabled drivers,

men of national merit, compact

cars, and low-emission cars

45 Seoul Baekje Museum



Public Transportation

Take the subway to Hanseong Baekje Station (Line 9) and walk for 6 minutes from the elevator at Exit No. 2.

Facilities

Toilet for the disabled

Next to Special Exhibition Hall (B1F), next to Permanent Exhibition Hall 3 (1F)

Family toilet Toilet (1F)

Diaper deck Nursing room

Nursing room Childcare Room (B1F)

Wheelchair rental

Information Desk (B2F)

Stroller rental Information Desk (B2F)

Operating Hours

Weekdays 9:00~19:00

Weekends & Holidays 9:00~18:00

November - February 9:00~18:00

* Closed on Mondays, January 1st, other dates designated by the city

Parking

Vehicles for less than 20 passengers

Minimum KRW 1,000 for 2 hrs

Additional fee

KRW 150 every 5 mins after 2 hrs

Vehicles for more than 20 passengers

Minimum KRW 2,000 for 2 hrs

Additional fee

KRW 250 every 5 mins after 2 hrs

* 50% off for the disabled drivers, men of national merit, compact cars, and low-emission cars

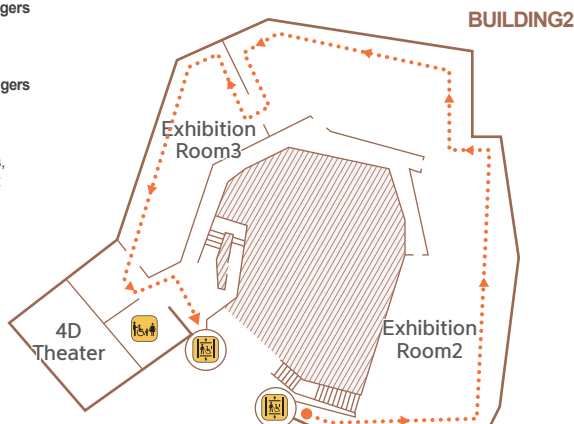
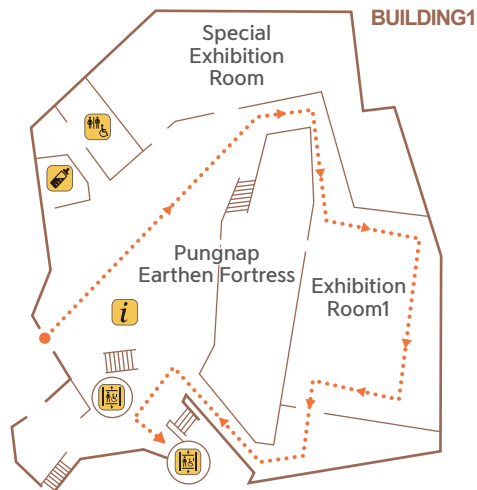

46 Olympic Park

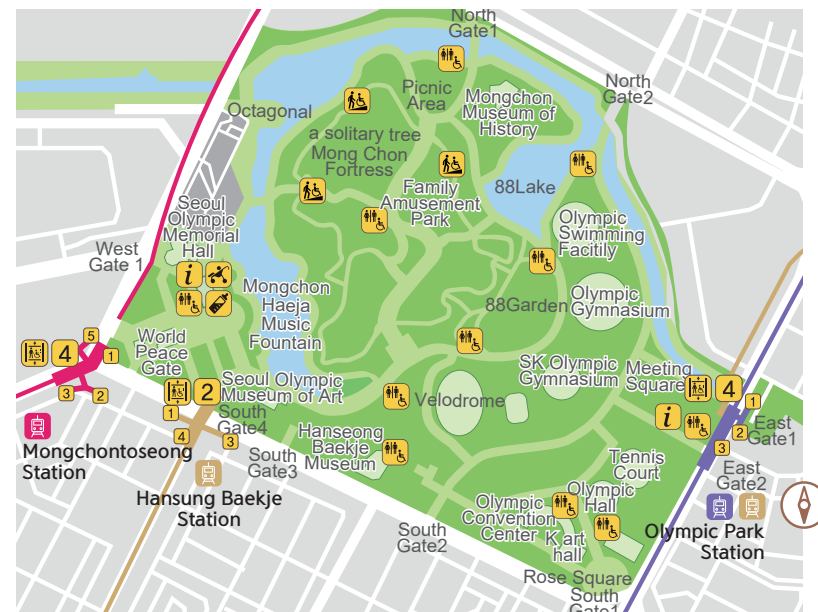

Public Transportation

Take the subway to Olympic Park Station (Line 5 & 9) and take an elevator at Exit No. 4.

Facilities

Toilet for the disabled

All toilets within the park

Family toilet

Mom & Babies' Room in women's room

Diaper deck

Nursing room inside Information Desk

Nursing room Information Desk

Wheelchair rental Information Desk

Stroller rental Information Desk

Operating Hours

Square 5:00~24:00

For vehicles 6:00~24:00

For walking and bicycles

5:00~22:00

* Always open

Parking

Operating Hours 6:00~24:00

Compact car KRW 1,000 for 1 hr

Additional fee

KRW 500 every 10 mins after 1 hr

Full-sized car (for more than 24 passengers, larger than 2.5 tons)

KRW 12,000

* 50% off for the disabled drivers, men of national merit, compact cars, and low-emission cars

47 Seoul Rose Park

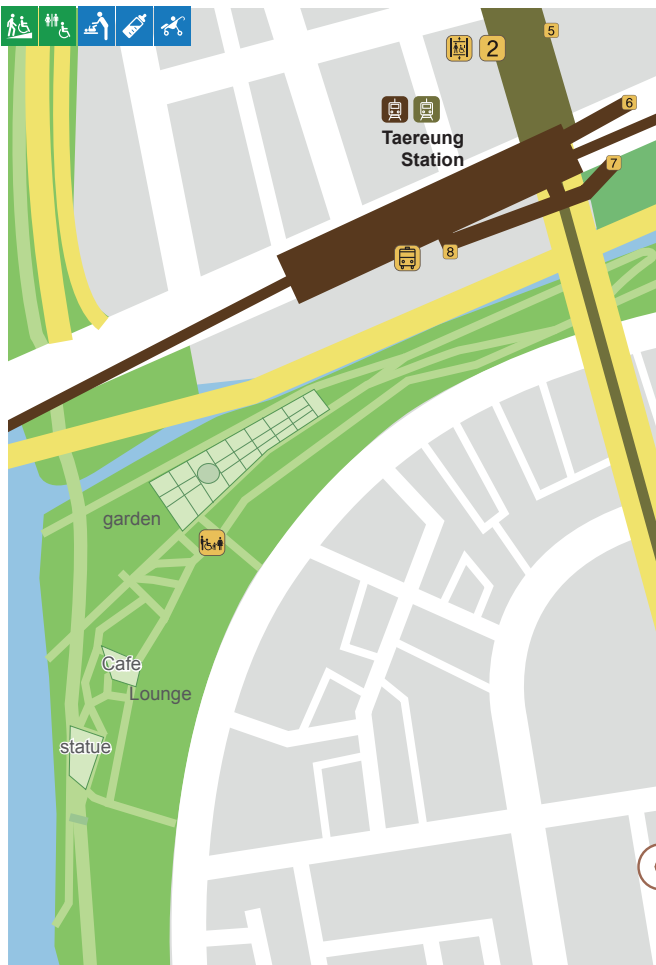

Public Transportation

Take the subway to Taereung Station (Line 6 & 7) and walk for 7 minutes from the elevator at Exit No. 2.

Facilities

Toilet for the disabled
Inside the outdoor toilet on the way to the open-air stage and sculpture after Rose Tunnel
Family toilet Share the toilet for the disabled
Diaper deck Inside the toilet for the disabled

Operating Hours

Always open

48 Seoul Upcycling Plaza



Public Transportation

Take the subway to Janghanpyeong Station (Line 5) and walk for 10 minutes from the elevator at Exit No. 8.

Facilities

Toilet for the disabled
Next to East Gate (1F), Business Support Office (1F), in front of West Gate (1F, 2F, 3F, 4F, 5F)
Family toilet In front of West Gate (1F, 2F, 3F, 4F, 5F)
Diaper deck Next to East Gate (1F), next to Business Support Office (1F), inside nursing rooms in the men's / women's room
Nursing room Next to East Gate (1F)
Wheelchair rental
Information Desk (1F)
Stroller rental
Information Desk (1F)
Stroller parking
Information Desk (1F)

Operating Hours

10:00~18:00
* Closed on Mondays, Lunar New Year's Day & Chuseok

Parking

Free for the first 20 mins
Additional fee
KRW 150 every 5 mins after 20 mins (Maximum KRW 36,000 per day)
* 80% off for the disabled drivers

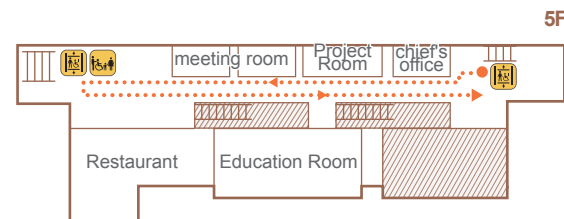
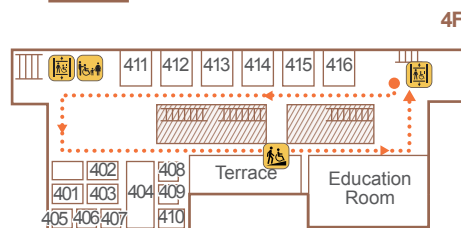
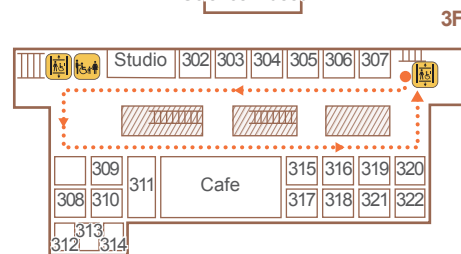
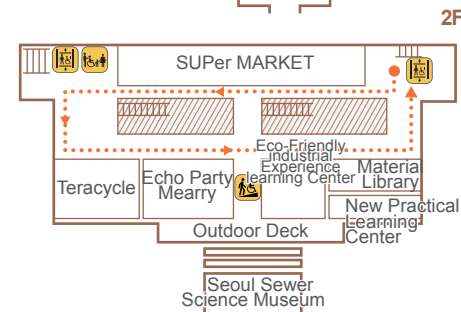
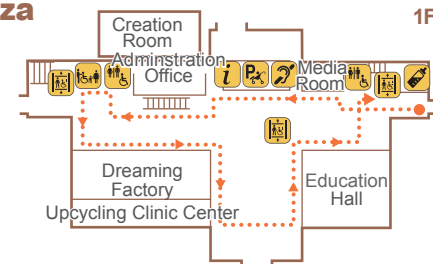

49 Seoul Sewerage Science Museum



Public Transportation

Take the subway to Janghanpyeong Station (Line 5) and walk for 15 minutes from the elevator at Exit No. 8.

Facilities

Toilet for the disabled

Outside family toilet (1F), inside family toilet (2F)

Family toilet Right of staircases (1F), next to Sewerage Protion (2F)

Diaper deck Toilet for the disabled (1F, 2F), Nursing room (2F)

Nursing room Next to Library (2F)

Wheelchair rental Information Desk (1F)

Stroller rental Information Desk (1F)

Stroller parking Information Desk (1F)

Operating Hours

9:00~17:00

* Closed on Mondays, January 1st, Lunar New Year's Day & Chuseok

Parking

Free for the first 30 mins

Additional fee

KRW 300 every 10 mins after 30 mins

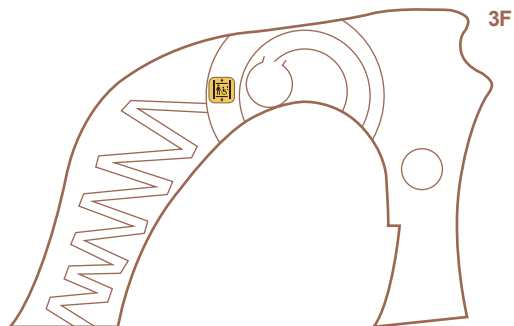
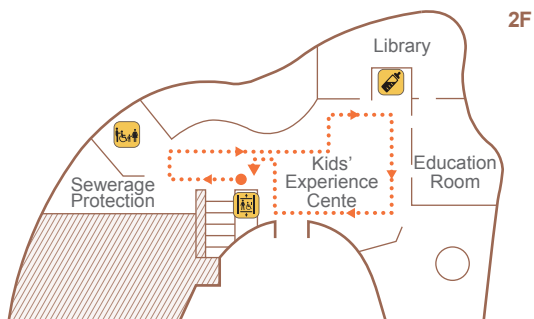
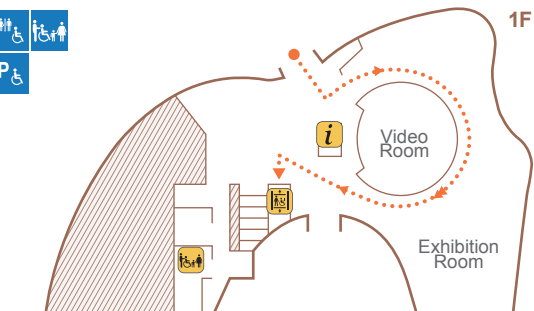

50 Seoul Children's Museum



Public Transportation

Take the subway to Children's Grand Park Station (Line 7) and walk for 6 minutes from the elevator at Exit No. 1.

Facilities

Toilet for the disabled

Inside B1F, outside 1F, insides 2F, inside 3F

Family toilet All toilets

Diaper deck All toilets

Nursing room next to Baby Playground (2F), near Group Restaurant 2 (3F)

Wheelchair rental

Information Desk (1F), ticket booth

Stroller rental

Rental from Seoul Children's Grand Park

Stroller parking Behind ticket booth (1F)

Operating Hours

10:00~18:00 (Last entrance at 17:00)

* Closed on Mondays, January 1st, Lunar New Year's Day & Chuseok, or any repair period

Parking

Sedan KRW 300 every 10 mins

Midsize car KRW 600 every 10 mins

Full-sized car KRW 900 every 10 mins

* 80% off for the disabled drivers, men of national merit, and the patients who suffer from aftereffects of exposure to defoliants

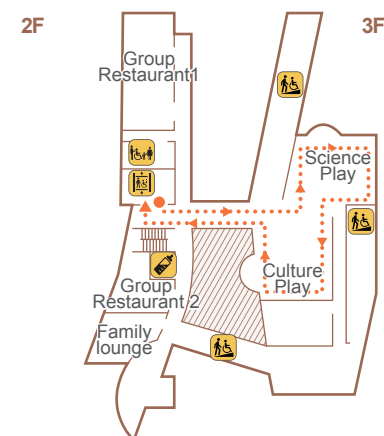
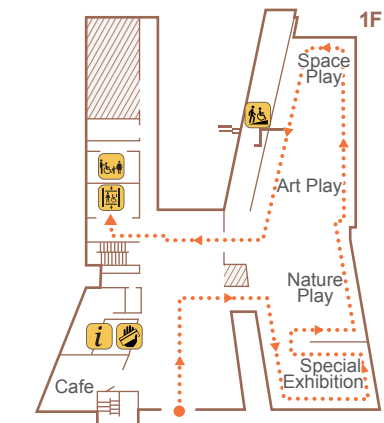
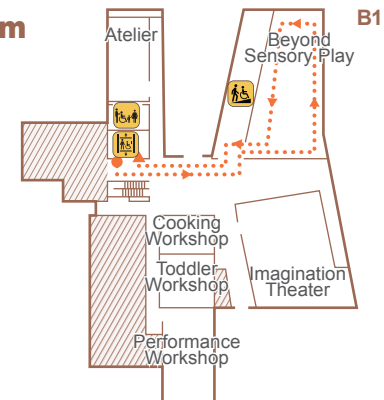

51 Seoul Children's Grand Park



Public Transportation

Take the subway to Children's Grand Park Station (Line 7) and take the elevator No.3 after No.1.

Facilities

Toilet for the disabled

Near the entrance, next to Saessakmaru, next to Herb Garden

Family toilet Combined use with toilet for the disabled

Diaper deck Toilet for the disabled, Nursing room

Nursing room

Near the entrance, next to Herb Garden, next to Ferocious-Animal Village

Wheelchair rental Information Desk

Stroller rental

Rental Center Next to the Customer Information Center

Operating Hours

5:00~22:00

Zoo & Botanical Garden

10:00~17:00

* Botanical Garden: open from 13:00 on Monday

Parking

Sedan KRW 150 every 5 mins

Midsize car KRW 300 every 5 mins

Full-sized car KRW 450 every 5 mins

* 80% off for the disabled drivers, men of national merit, and the patients who suffer from aftereffects of exposure to defoliants

* 50% off for compact cars, low-emission cars and Dadoongee card (family card with three children) holders

* 30% off for Dadoongee card (family card with two children) holders

52 Seoul Forest Park



Public Transportation

Take the subway to Seoul Forest Park Station (Suin Bundang Line) and take an elevator at Exit No. 3. 7 minutes away on foot.

Facilities

Toilet for the disabled

Visitor Center in front, next to Sports Park, next to Community Center, behind Eco Experience Center

Family toilet Combined use with toilet for the disabled, Kid's toilet and changing table available inside the toilet

Diaper deck

Inside family toilet and toilet for the disabled

Nursing room

Visitor Center, Community Center

Wheelchair rental Visitor Center

Stroller rental Visitor Center

Operating Hours

Seoul Forest Park Always open

Eco Forest (Deer Corral, Footbridge)

05:30~21:30 (Eco Conservation Area)

* Deer feeding is not available for sales from January 1, 2020

Insect Garden

10:00~17:00 (Closed on Mondays)

Butterfly Garden 10:00~17:00 (May -

October, Closed on Mondays)

* Closing season (November - April)

Insect Garden available on the 2nd floor

Open only when operating a specific program (e.g. Eco Experience Center) (Occasional basis)

Floor fountain operation hours May - September (Regular inspection every Monday)

May - June & September - four times for 30 mins every 13:00, 14:00, 15:00, 16:00

July - August & December, five times for 30 mins every 13:00, 14:00, 15:00, 16:00

Lake fountain operation hours May - September 2 times for 30 mins every 14:00, 17:00 on Saturdays

* Currently not in operation

Visitor Center

(Information Desk, Seoul Forest Park Story, Nursing room available)

10:00~18:00 (Always open)

Winter 10:00~7:00 (November - February)

Community Center (Waterside lounge, Exhibition room, Seminar room, Nursing room)

Open only when operating a specific program or exhibition (Occasional basis)

Parking

Compact car KRW 150 every 5 mins

Full-sized car KRW 300 every 5 mins

Weekdays 12:00~19:00

Weekends 10:00~19:00

* 80% off for the disabled drivers, men of national merit, and the patients who suffer from aftereffects of exposure to defoliants

PART.4

GANGSEO

53 Oil Tank Culture Park

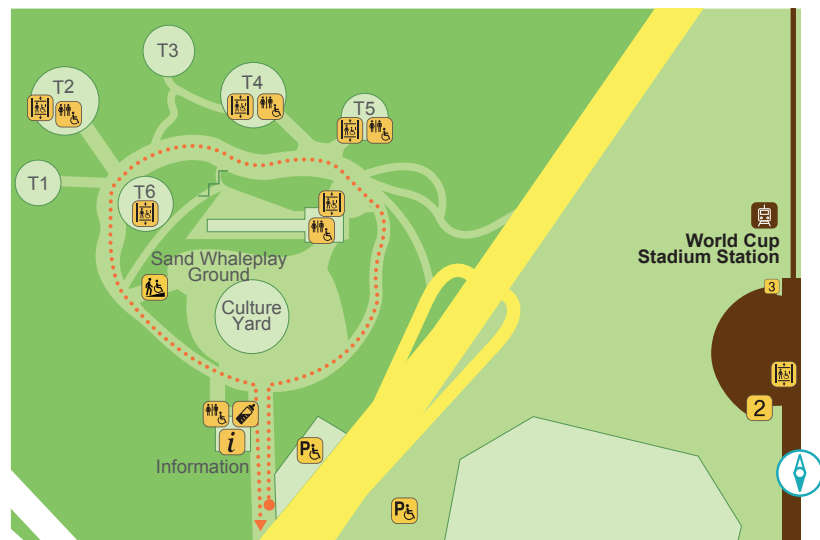

Public Transportation

Take the subway to World Cup Stadium Station (Line 6) and walk for 10 minutes from the elevator at Exit No. 2.

Operating Hours

T0 Always open
T1~6 10:00~18:00
T1~6 Closed on Mondays and January 1st

Facilities

Toilet for the disabled

Information T2, T4, T5, T6

Family toilet T6

Diaper deck

Nursing room, T6 family toilet

Nursing room Information building

Wheelchair rental

Information building

Stroller rental Information building

Stroller parking Information building

P Parking

Compact car

KRW 300 every 10 mins

Midsize car

KRW 600 every 10 mins

* 80% off for the disabled drivers and men of national merit

* 50% off for compact cars, low-emission cars

* 30~50% off for Dadoongee card holders

54 Haneul Park



Public Transportation

Take the subway to Mapo-gu Office Station (Line 6) and walk for 20 minutes from the elevator at Exit No. 2.

Operating Hours

Entrance allowed from 5:00 to
January 20:00 / **February** 20:30 / **March** 21:00 /
April 21:30 / **May** 21:30 / **June** 22:00 / **July** 22:00 /
August 22:00 / **September** 21:00 / **October** 20:30 / **November** 19:30 / **December** 19:30 /
 * Always open

Facilities

Toilet for the disabled

Visitor Information Office, next to the Sky Staircase, next to Wind Power Generator, next to the silver grass field

Family toilet

Inside toilet for the disabled

Diaper deck

Toilet for the disabled, nursing room

Nursing room

Visitor Information Office

Wheelchair rental

Visitor Information Office

Stroller rental Visitor Information Office

P Parking

Sedan KRW 5,000 for 4 hrs

Additional fee KRW 150 every 5 mins after 4 hrs

Midsize car(minibus) KRW 10,000 for 4 hrs

Additional fee KRW 300 every 5 mins after 4 hrs

Full-sized car KRW 15,000 for 4 hrs

Additional fee KRW 450 every 5 mins after 4 hrs

* 80% off for the disabled drivers and men of national merit

* 50% off for compact cars, low-emission cars

* 30~50% off for Dadoongee card holders

* 30% off for Noel Leisure Center Program participants

55 Pyeonghwa Park

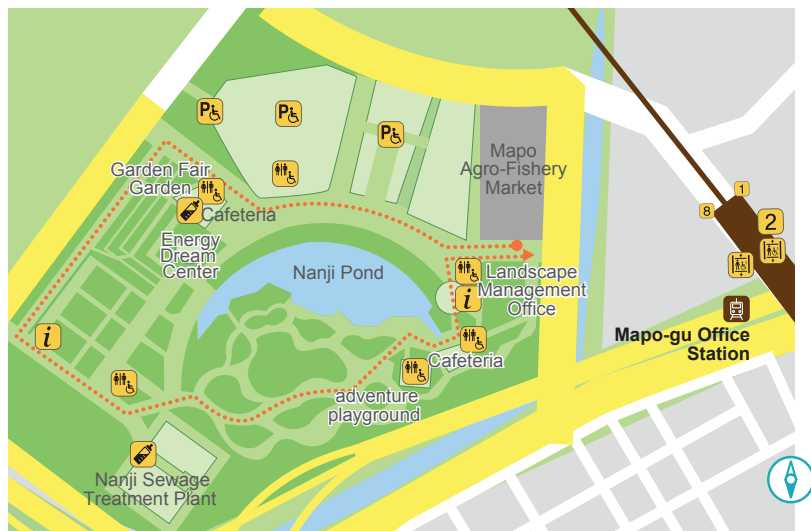

Public Transportation

Take the subway to Mapo-gu Office Station (Line 6) and walk for 7 minutes from the elevator at Exit No. 2. Free shuttle service provided for the disabled and the elderly at the Mapo-gu Office

Facilities

Toilet for the disabled

Inside Green Project Office in all toilets within the park, next to the cafe, in front of the playground

Family toilet

Combined use with toilet for the disabled

Diaper deck

Toilet for the disabled, general toilets

Nursing room

Cafeteria, Nanji sewage treatment plant

Wheelchair rental Information Desk

Stroller rental Information Desk

Operating Hours

January 5:00~20:00

February, October 5:00~20:30

March, September 5:00~21:00

April, May 5:00~21:30

June, July, August 5:00~22:00

November, December 5:00~19:30

Byeoljari Store & Lounge, Lake Store & Lounge 10:00~22:00

Nursing room 9:00~18:00

Playground for pets

March~April, September~November

10:00~20:00

May~August 10:00~21:00

(Inquiry: Animal protection department, Seoul city 02-2133-7657)

Sun Shelter

April~October 9:00~18:00

Parking

Sedan KRW 5,000 for 4 hrs

Additional fee

KRW 150 every 5 mins after 4 hrs

Midsized car(minibus)

KRW 10,000 for 4 hrs

Additional fee

KRW 300 every 5 mins after 4 hrs

Full-sized car

KRW 15,000 for 4 hrs

Additional fee

KRW 450 every 5 mins after 4 hrs

* 80% off for the disabled drivers

and men of national merit

* 50% off for compact cars, low-emission cars

* 30~50% off for Dadoongee card holders

* 30% off for Noel Leisure Center

Program participants

56 Seonyudo Park



Public Transportation

Take the subway to Seonyudo Station (Line 9) and walk for 3 minutes from Exit No. 2 elevator. Take a low floor bus (bus #603, 761, 5714, 7612).

Facilities

Toilet for the disabled

Next to Story Center Eco Class, Management office

Family toilet

Next to Story Center Eco Class, Management office

Diaper deck Nursing room, nursing room inside men's/women's room, Management office

Wheelchair rental Management office

Stroller rental Management office

Stroller parking Management office

Operating Hours

6:00~24:00 * Always open

Parking

Free for the disabled driver only

57 Gyeongjae Jeongseon Art Museum



Public Transportation

Take the subway to Yangcheon Hyanggyo Station (Line 9) and take a low floor bus #6642 at Exit No.3. Get off at the next stop and walk for 3 minutes.

Facilities

Toilet for the disabled
Women's room (1F) Men's room (3F)
Family toilet Inside all toilets
Diaper deck Nursing room, toilet
Nursing room 2F
Wheelchair rental Information Desk (1F)
Stroller rental Information Desk (1F)

Operating Hours

March - October
10:00~18:00 (Last entrance at 17:00)
November - February
10:00~17:00 (Last entrance at 16:00)
Weekends & Holidays
10:00~17:00 (Last entrance at 16:00)
* Closed on Mondays, January 1st,
Lunar New Year's Day & Chuseok

Parking

Compact car
Minimum KRW 3,000 for 2 hrs
Additional fee
KRW 800 every 10 mins after 2 hrs
Mid/full-sized car
Minimum KRW 5,000 for 2 hrs
Additional fee
KRW 800 every 10 mins after 2 hrs
* 80% off for the disabled drivers
and men of national merit

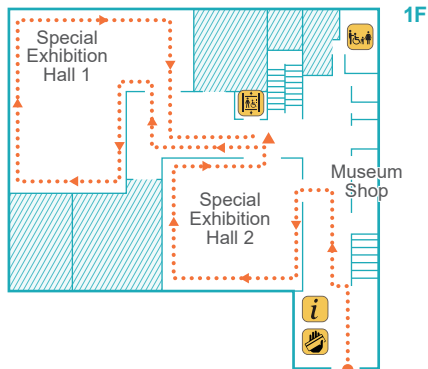

1F

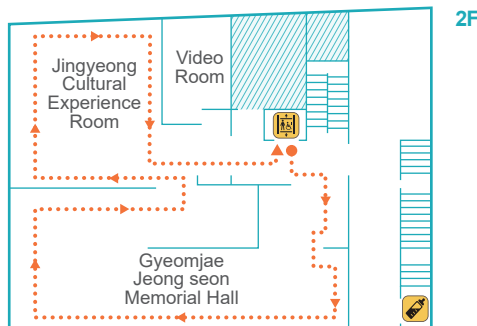

2F

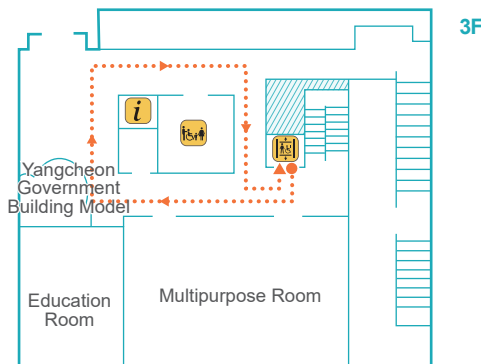

3F

58 Seoul Botanic Park

OUTDOORS



Public Transportation

Take the subway to Magongnaru Station (Line 9 & Airport Railroad) and walk for 14 minutes from the elevator between exit No. 3 and 4.

Facilities

Toilet for the disabled Visitor Center
Family toilet
Inside toilet for the disabled
Diaper deck
Inside family toilet and nursing room
Nursing room Visitor Center
Botanic (1F)
Wheelchair rental Information Desk
Stroller rental Information Desk

Operating Hours

Open Forest, Lake Garden, Marsh Garden Always open
Jujewon
March - October 9:30~18:00
November - February 9:30~17:00
* Jujewon: Closed on Mondays

Parking

Compact car
KRW 200 every 10 mins
Midsized car
KRW 400 every 10 mins
Full-sized car
KRW 600 every 10 mins
* 80% off for the disabled drivers

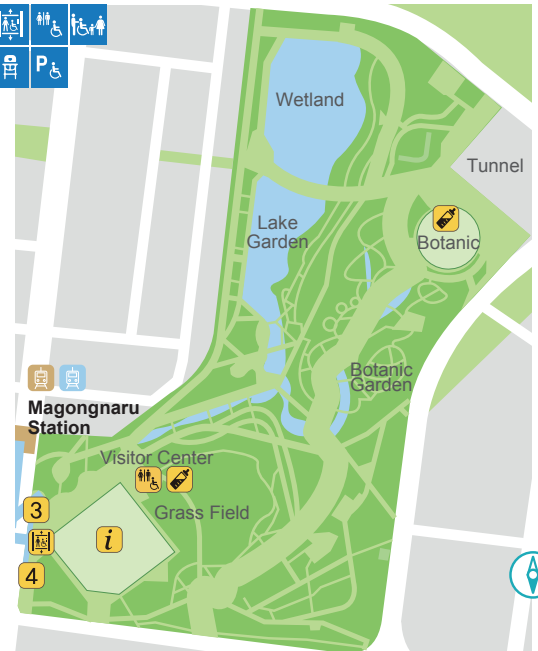

INDOORS B1

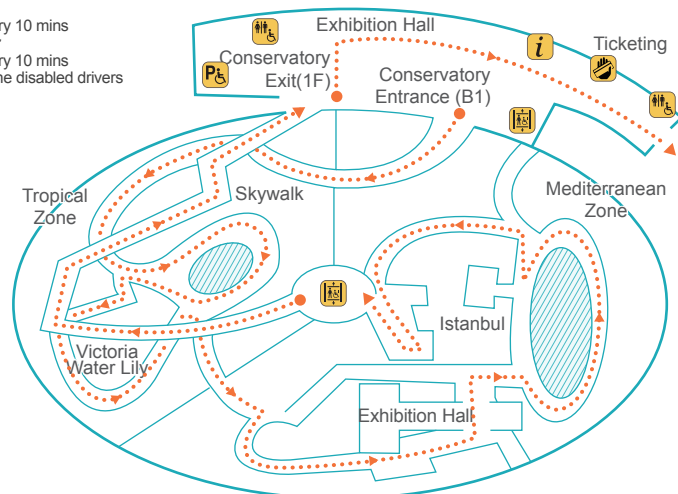

59 Seoseoul Lake Park



Public Transportation

Take the subway to Hwagok Station (Line 5) and take an elevator at Exit No.2. Walk toward the Hwagok Hyundai Gas Station. Take a low floor bus #653 to Seoseoul Lake Park Station.

Facilities

Toilet for the disabled
Information Center

Family toilet

Inside toilet for the disabled

Nursing room Information Center

Wheelchair rental Information Center

Stroller rental Information Center

Operating Hours

9:00~18:00 * Closed on Mondays

Parking

Seoseoul Public Parking

KRW 600 for 1 hr

Additional fee 50 every 5 mins after 1 hr

* Pay by only credit card Vehicles for more than 12 passengers and larger than 1 ton not allowed for parking.

* 80% off for the disabled drivers and men of national merit

60 Pureun Arboretum



Public Transportation

Take the subway to Onsu Station (Line 1 & 7) and walk for 30 minutes from the elevator between exit No. 2 and 3.

Facilities

Toilet for the disabled

Near main gate

Family toilet

Inside toilet for the disabled

Diaper deck Inside toilet for the disabled and nursing room

Nursing room Management office outside of Pureun Arboretum

Wheelchair rental Information Office

Stroller rental Information Office

Operating Hours

Outdoor 5:00~22:00

Greenhouse Flower Garden 9:00~18:00

* Always open

Parking

Sedan (occupying 1 block)

KRW 150 every 5 mins

Midsize car (occupying 2 blocks)

KRW 300 every 5 mins

Full-sized car (occupying 3 blocks)

KRW 450 every 5 mins

* Maximum KRW 12,000 per day

Gangbuk

1. Seodaemun Independence Park	1
2. Gyeonghuigung Palace	2
3. Seoul Museum of History	3
4. Cheongwadae Sarangchae	4
5. Gyeongbokgung Palace	5
6. The National Folk Museum of Korea	6
7. National Museum of Modern and Contemporary Art Seoul	6
8. Changdeokgung Palace	7
9. Jongmyo Shrine	8
10. Changgyeonggung Palace	9
11. National Children's Science Center	10
12. Marronnier Park	10
13. Seoul Metropolitan Library	11
14. Deoksugung Palace	12
15. Seoul Museum of Art	13
16. Seoul Animation Center	14
17. Seoulo 7017	14
18. Culture Station Seoul 284	15
19. Kim Koo Museum & Library	16
20. Crown Haitai Kids Museum	16
21. The War Memorial of Korea	17
22. Namsan Cable Car	18
23. N Seoul Tower	19
24. Namsangol Hanok Village	19
25. Nodeulseom Island	20
26. National Museum of Korea	21
27. National Hangeul Museum	22
28. Yongsan Park	23
29. Dooly Museum	24
30. Dream Forest	25
31. Seoul Science Center	26
32. Buramsan Butterfly Garden	27
33. Savina Museum of Contemporary Art	28

Gangnam

34. Hyundai Motor Studio Seoul	29
35. Seolleung and Jeongneung Royal Tombs	30
36. COEX	31
37. Boramae Park	32
38. Gwanaksan Mountain Nakseongdae Park	32
39. Seoul National Cemetery	33
40. Seoul Arts Center	34

Gangdong

41. LOTTE WORLD AQUARIUM	35
42. SEOUL SKY	36
43. Seoul Olympic Museum of Art	37
44. Mongchontoseong Fortress	38
45. Seoul Baekje Museum	39
46. Olympic Park	40
47. Seoul Rose Park	41
48. Seoul Upcycling Plaza	42
49. Seoul Sewerage Science Museum	43
50. Seoul Children's Museum	44
51. Seoul Children's Grand Park	45
52. Seoul Forest Park	46

Gangseo

53. Oil Tank Culture Park	47
54. Haneul Park	48
55. Pyeonghwa Park	49
56. Seonyudo Park	50
57. Gyeongjae Jeongseon Art Museum	51
58. Seoul Botanic Park	52
59. Seoseoul Lake Park	53
60. Pureun Arboretum	54